

General Office and Factory: Wichita, Kansas U.S.A. 67219
THE COLEMAN COMPANY, INC.

Made in United States of America

THE COLEMAN COMPANY, INC.
 3600 N. Hydraulic, Wichita, Kansas 67219, 1-800-835-3278
 TDD: 316-261-3207

NOTE: To the extent any provision of this warranty is prohibited by federal, state, or local law and cannot be preempted, it shall not be applicable. This warranty gives you specific rights and you may also have other rights which vary from state to state.

Take the product to an authorized Coleman Service Center. If one is not conveniently located, attach a tag to the product which includes your name, address, telephone number and description of the problem. Include a copy of the original sales receipt. Carefully package the product and send prepaid either by U.P.S. or Parcel Post, insured, to: Coleman Outdoor Products, Inc., 3600 N. Hydraulic, Wichita, KS 67219. Please do not mail products with fuel in tanks, or with disposable propane cylinders. Remove glass globes from lanterns.

HOW TO OBTAIN WARRANTY PERFORMANCE

Any implied warranties, including implied warranties of merchantability and fitness for a particular purpose, shall be limited to the duration and terms of the express warranties set forth in the limited warranty. Some states do not allow limitations on how long an implied warranty lasts, so the above limitation may not apply to you.

IMPLIED WARRANTIES

- States do not allow the exclusion or limitation of incidental or consequential damages, so the above limitation or exclusion may not apply to you.
- Consequential damages, incidental damages, or expenses, including damages to property, some lanterns.
- Products used for commercial purposes or in profit or non-profit instructional or rental operations.
- Samosa
- Products sold outside the United States, Puerto Rico, Virgin Islands, Guam, Canal Zone or American Samoa
- Coleman accessories or parts, or failure to follow recommended care or maintenance instructions
- Damage caused by misuse, abuse, neglect, alterations, repairs by unauthorized persons, use of non-sure to sunlight
- Normal wear and tear, including chips, scratches, abrasion, discoloration or fading from use or exposure
- Cost of shipment to Coleman

WHAT IS NOT COVERED

Coleman will repair or replace, at its option, this product or any component found to be defective in materials or workmanship within three years of the original retail purchase. This warranty is valid for the original retail purchase and is not transferable. Keep the original sales receipt. Proof of purchase is required to obtain warranty performance. Coleman dealers, service centers, or retail stores offering Coleman products do not have authority to alter, modify or in any way change the terms or conditions of this warranty.

3 Year Limited Warranty



How to Use and Enjoy Your Coleman® UltraLight Gear Lantern Model 226-700

U.S. PATENT NO.
 R. E. 29,457 + 4,181,760

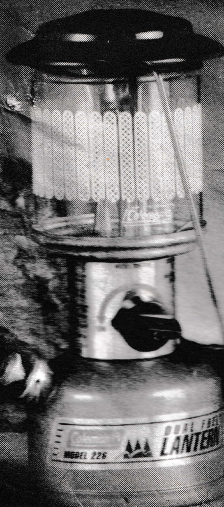

Operates on
 Coleman® Fuel or
 unleaded gasoline



Parts List For Coleman® UltraLight Gear® Lantern model 226

I.D. NO.	PART NO.	DESCRIPTION
1	226-4871	Ventilator
2	226-0481	Globe
3	226-4211	Bail
4	5414A3261	Burner Assy.
5	#20	Mantle
6	220C1401	Filler Cap
7	226-1611	Fount Comp.
8	400E5201	Pump Plunger Assy.
9	222A6565	Valve Assy.
10	226-4941	Knob and Screw
11	226-2991	Generator
12	226-5801	Lantern Maintenance Kit (Not Shown) Includes Items 11, 20 & 21
13	226-5611	Service Parts Kit (Not Shown) Includes Items 15, 16, 17, 18 and 19
14	400-6381	Check Valve and Stem Assy.

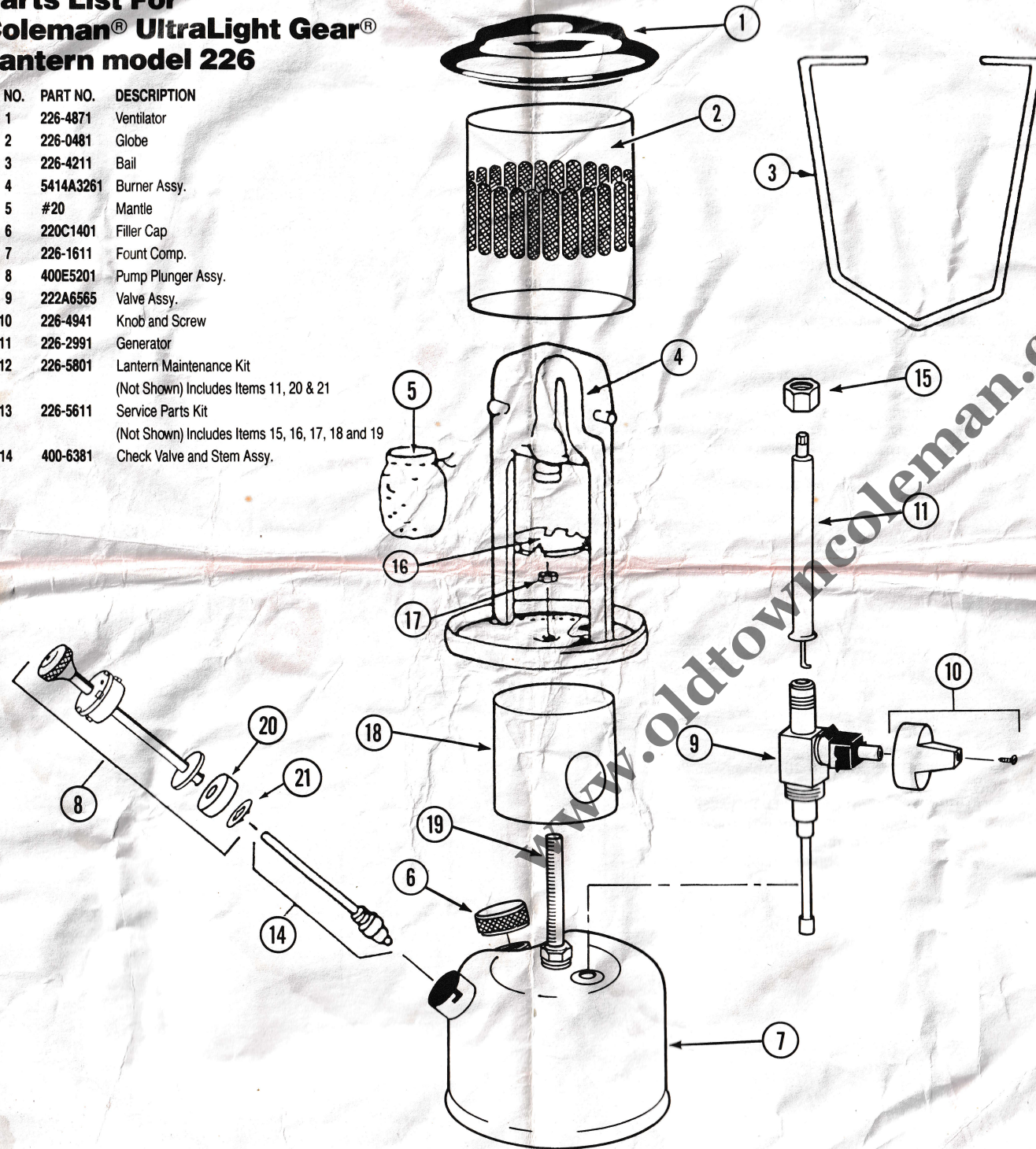

The Generator

If your lantern is hard to light or burns dimmer than normal, the generator may need to be replaced.

1. Move away from all ignition sources including pilot lights.
2. Loosen FUEL CAP to release pressure in the fuel tank.
3. Remove BAIL, VENTILATOR, GLASS GLOBE and HEAT SHIELD.
4. Unscrew FRAME NUT and lift FRAME from lantern.
5. Unscrew the KNOB SCREW and remove FUEL VALVE KNOB.
6. Lift off BASE REST.
7. Turn FUEL VALVE to position shown in Fig. 1. (Note flat area).
8. Unscrew GENERATOR NUT, lift GENERATOR and unhook CLEANING ROD.
9. On new GENERATOR, pull CLEANING ROD down about 1/4 inch.
10. Hook CLEANING ROD into VALVE and turn FUEL VALVE to position shown in Fig. 2. (Note flat area).
11. Slide old GENERATOR NUT over top of new GENERATOR and tighten nut firmly to form a leak tight joint. Hold GENERATOR straight while tightening nut.
12. Reassemble lantern. Make sure the top of the GENERATOR enters the OPENING in BURNER when attaching BURNER to LANTERN. Also, the flat area on the FUEL VALVE has to fit into the flat area inside the FUEL KNOB.
13. Tighten FUEL CAP, replace MANTLE if damaged, and visually check for any fuel leaks immediately after lighting.

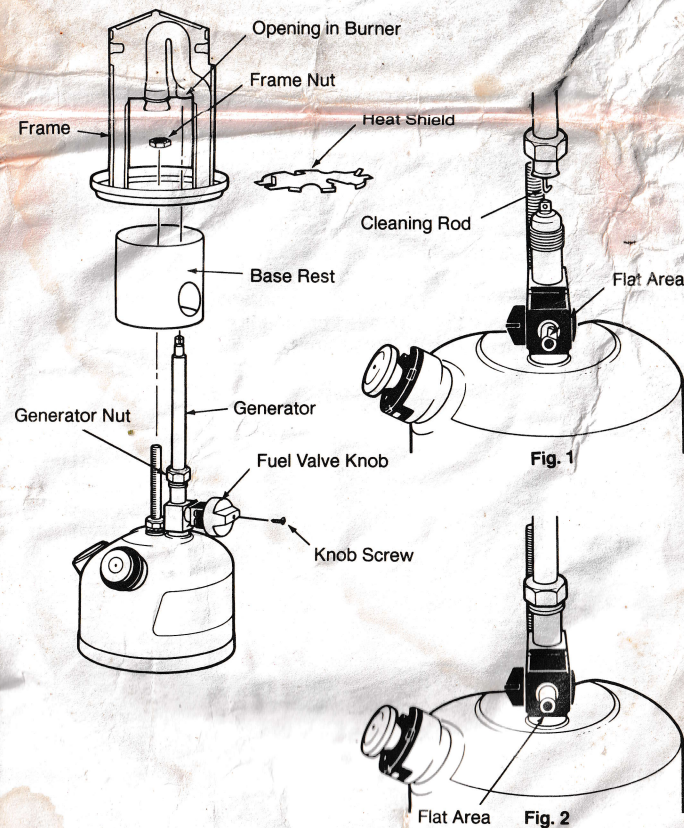

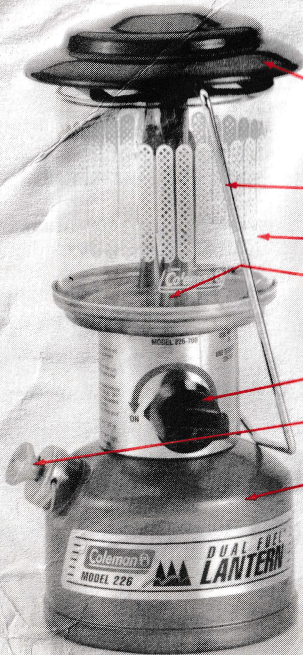

1. Ventilator
2. Bail
3. Globe
4. Heat Shield
5. Fuel Valve
6. Pump Knob
7. Tank

1 Follow Instructions And Warnings To Avoid Injury Or Fires.

WARNING:

1. Coleman fuel and unleaded gasoline are extremely flammable, handle with extreme care. Fuel vapors are invisible, explosive, and can be ignited by ignition sources many feet away.
2. This lantern is designed to use Coleman fuel or unleaded gasoline only. Never use leaded automotive fuel.
3. Store fuel in a clean, properly marked container away from flame (including pilot lights), other sources of ignition, or excessive heat.
4. Always fill outdoors. Never fill lantern, loosen or remove fuel cap while lantern is lighted, near flame (including pilot lights), other ignition sources, or while top of lantern is hot to touch.
5. Always light and use lantern outdoors; never inside house, camper, tent, or other unventilated or enclosed areas.
6. This lantern consumes air (oxygen). Do not use in unventilated or enclosed areas to avoid endangering your life.
7. Keep lantern away from flammables. Never allow fabric, clothing, or any flammable material to come within four feet of the top and one foot of the side of the lantern.
8. Use for lighting only. Never alter in any way or use with any device or part not expressly approved by Coleman. Do not use as a space heater.
9. Replace any mantle with a hole in it. A hole can cause lantern to overheat and create a hazard.
10. Keep out of reach of children.

2 To Fill

Always fill outdoors. Never fill lantern, loosen or remove fuel cap while lantern is near flame (including pilot lights), other ignition sources, or while top of lantern is hot to touch.

1. Turn FUEL VALVE to "OFF". (Fig. 1)
2. Close PUMP KNOB firmly. Turn in direction of arrow. (Fig. 2)
3. Remove FUEL CAP. Use a funnel or suitable filling device and fill with clean, fresh fuel. Lantern must be in a level position to avoid overfilling. DO NOT TIP. (Fig. 3)
4. Replace FUEL CAP on lantern and on fuel container. Tighten firmly. WIPE UP ANY SPILLED FUEL AND DISPOSE OF IN A SAFE PLACE.

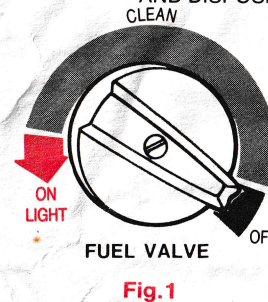

Fig. 1

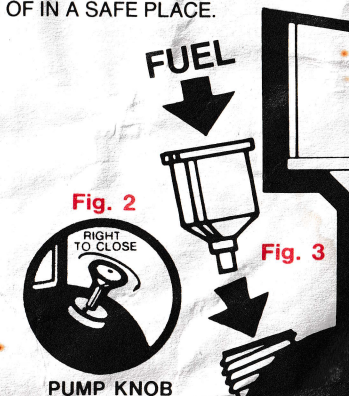

Fig. 2

Fig. 3

4 To Pump

1. Be sure FUEL VALVE is in the "Off" position and that the FUEL CAP is tightened firmly.
2. Open PUMP KNOB one turn.
3. With thumb over hole in PUMP KNOB, pump approximately 30 strokes. If lantern is not full of fuel, more pump strokes are required.
4. Close PUMP KNOB firmly.

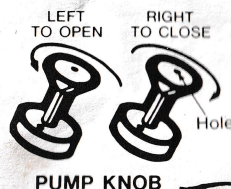

Fig. 5

5 To Light

1. Push lighted MATCH through lighting hole; hold near mantle and turn FUEL VALVE to the "ON" position. (Fig. 6) The mantle will take a few seconds to light.
- CAUTION:** Flames other than at mantle indicate flooding or a leak. Turn FUEL VALVE "OFF". Permit flames to burn out and lantern to cool. Carefully review instructions and correct problem before relighting lantern.
2. Open PUMP KNOB and pump 10-20 strokes. Close PUMP KNOB.
3. Turn the FUEL VALVE from "ON" to "OFF" to "ON" several times. This will clean the small gas tip in the generator. Repeat as necessary during operation.
4. Additional pumping will be required at intervals for full light output.
5. To avoid burns to hands, do not leave bail in upright position while lantern is burning.

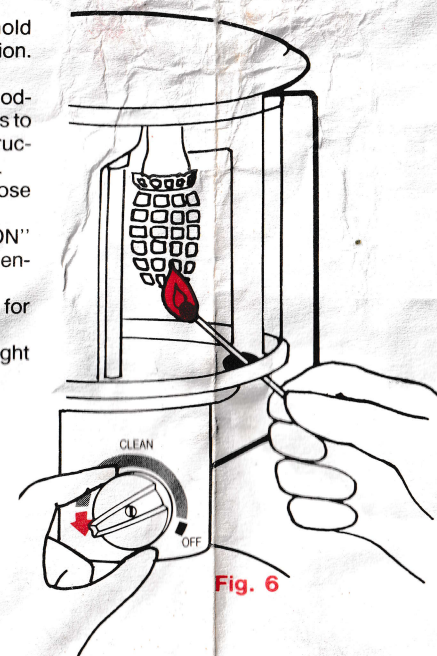
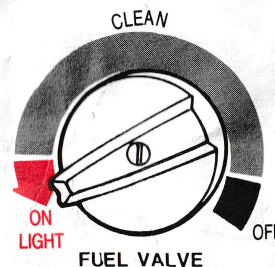

Fig. 6

6 To Turn Off

1. Turn FUEL VALVE to the "OFF" position. Light will dim and go out in approximately 1-2 minutes. **NOTE:** Allow lantern to cool before handling.

3

To Tie On Mantle

1. ALWAYS USE A COLEMAN #20 MANTLE.

This is a smaller MANTLE than the standard Coleman 21A MANTLE which is used on other Coleman gasoline and propane lanterns.

2. Tie MANTLE around grooves in BURNER. (Fig. 4) Distribute folds of MANTLE evenly.

3. Make sure HEAT SHIELD is in place.

4. Light bottom of MANTLE evenly. Burn until nothing but white ash remains. Once the MANTLE has been burned, it is very fragile. Be careful not to touch it with finger or match.

5. Allow MANTLE to cool before lighting lantern.

6. Install GLOBE, VENTILATOR, and WIRE

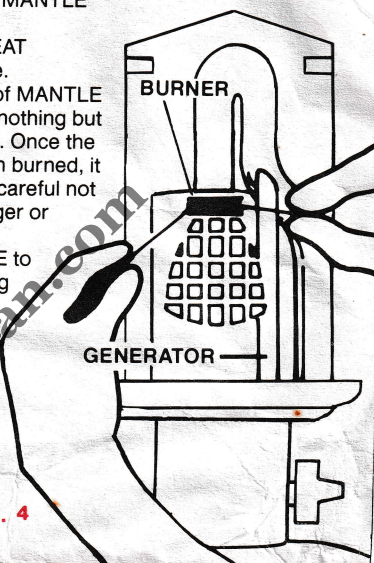

Fig. 4

Things You Should Know

1. Always carry spare Coleman #20 mantles. Mantles are fragile and easily damaged. To avoid breakage, never touch burned mantles with a match or fingers. Mantles are available at stores that handle Coleman or Coleman Peak 1 products.

2. Rinse tank twice a year with fresh fuel to remove sediment, gum formations, and moisture accumulations.

3. Oil pump periodically to keep it soft and pliable.

4. The usual storage areas for camping and picnic equipment is the basement, attic, or garage. To avoid the accumulation of dust, cobwebs, etc. that is common in these storage areas, place your lantern in a plastic bag and seal it with a rubber band.

5. Unleaded fuels may vary in quality and can affect generator life and performance. If you are having a problem with your stove or generator using unleaded fuel, replace the generator and try a different brand of unleaded fuel. Avoid unleaded fuels containing metallic additives such as MMT or other manganese compounds.

6. This lantern has a built-in generator cleaner. As you turn the fuel valve from "OFF" to "ON", the valve passes through the "CLEAN" position and cleans the small gas tip in the generator. The tip is cleaned by quickly moving through the "CLEAN" position. Do not try to clean the generator by leaving the valve in the "CLEAN" position. As you move from "ON" to "OFF", the light should dim as you pass through the "CLEAN" position and then return to full brightness in the "OFF" position for several seconds before dimming and going out.

7. For repair service call 1-800-835-3278 TOLL FREE for location of your nearest Coleman Service Center. If lantern must be mailed to Service Center, attach your name, address, and a description of problem to product and mail it to Service Center; prepaid, less globe, heat shield, and ventilator to prevent breakage. If necessary to write the Service Center or factory, refer to your lantern by specific model number.