

# How To Use and Enjoy Your **Coleman Lantern** **model 288A700**

U.S. PAT. NO. 4,522,582

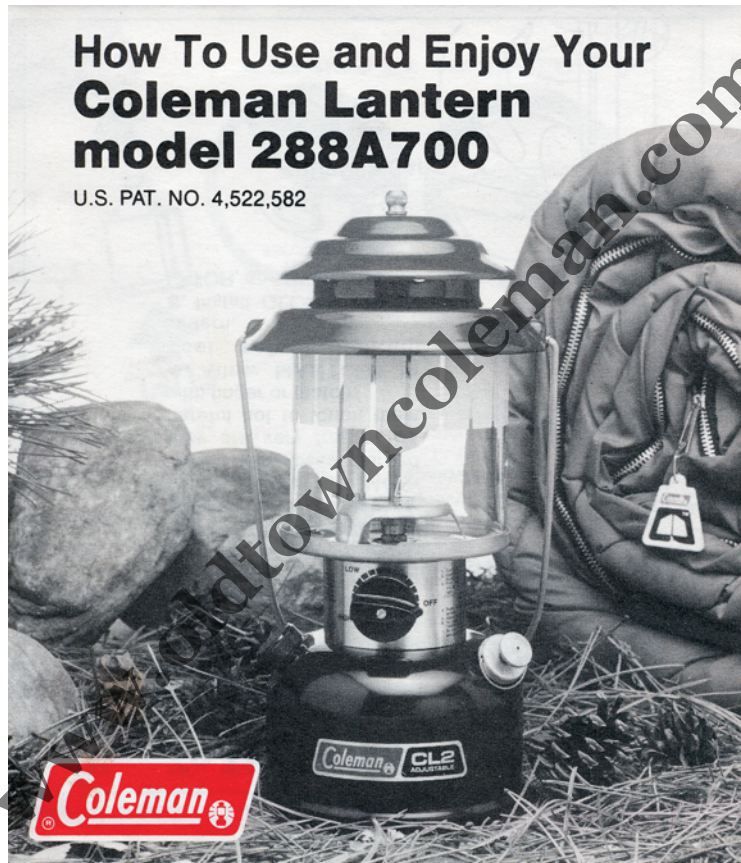



1. Ball nut
2. Ventilator & bail
3. Mantle
4. Globe
5. Spring Clip
6. Heat Shield
7. Fuel Valve
8. Fuel Cap
9. Pump Knob
10. Fount

# 1 Follow Instructions And Warnings To Avoid Injury Or Fires.

## WARNING:

1. This lantern consumes air (oxygen). Do not use in unventilated areas. Ample ventilation must be provided to avoid endangering your life. Provide additional ventilation for persons and other fuel burning appliances occupying the same enclosed area.
2. Fuel for your lantern is extremely flammable. Use the same care as when using gasoline.
3. This lantern is designed to use Coleman fuel. Never use kerosene, regular or premium leaded automotive fuel.
4. Store fuel in a clean, properly marked, metal container away from flame (including pilot lights), other sources of ignition, or excessive heat.
5. Always fill outdoors. Never fill lantern, loosen or remove fuel cap while lantern is lighted, near flame (including pilot lights), other ignition sources, or while top of lantern is hot to touch.
6. Always light lantern outdoors; never inside house, camper, tent or other enclosed areas.
7. Never allow tents, sleeping bags, clothing, or any flammable material to come within two feet of the top and one foot of all sides of the lantern.
8. Use for lighting only. Never alter in any way or use with any device or part not expressly approved by Coleman.
9. Replace any mantle with a hole in it. A hole can cause lantern to overheat and create a hazard.
10. Keep out of reach of children.

## 2 To Fill

Always fill outdoors. Never fill lantern, loosen or remove fuel cap while lantern is lighted, near flame (including pilot lights), other ignition sources, or while top of lantern is hot to touch.

1. Turn FUEL VALVE to "OFF". (Fig. 1)
2. Close PUMP KNOB firmly. Turn in direction of arrow. (Fig. 2)
3. Remove FUEL CAP. Use a funnel or suitable filling device and fill with clean, fresh fuel. Lantern must be in a level position. **DO NOT TIP.** (Fig. 3)
4. Replace FUEL CAP on lantern and on fuel container. Tighten firmly. **WIPE UP ANY SPILLED FUEL AND DISPOSE OF IN A SAFE PLACE.**

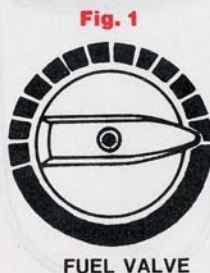

## 3 To Tie On Mantles

1. ALWAYS USE GENUINE COLEMAN MANTLES.

2. Tie MANTLES around grooves in BURNER CAPS. (Fig. 4) Distribute folds of MANTLE evenly. Cut off surplus string.

3. Light bottom of MANTLES evenly. Burn until nothing but white ash remains. Once the MANTLES have been burned they are very fragile. Be careful not to touch them with finger or match.

4. Allow MANTLES to cool before lighting lantern.

5. Install GLOBE, VENTILATOR, and BALL NUT.

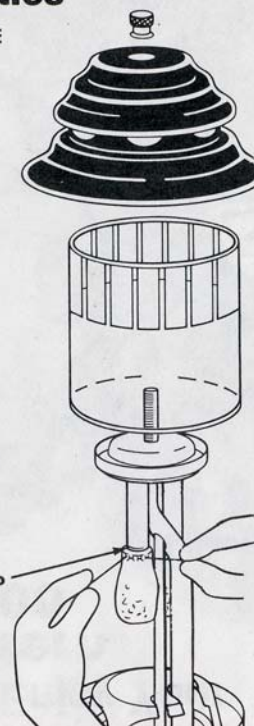



# 4

## To Pump

1. Be sure FUEL VALVE is "Off" and fuel cap is closed firmly.
2. Open PUMP KNOB one turn.
3. With thumb over hole in PUMP KNOB, pump approximately 30 strokes. If lantern is not full of fuel, more pump strokes are required. **GOOD AIR PRESSURE IS IMPORTANT.**
4. Close pump knob firmly.

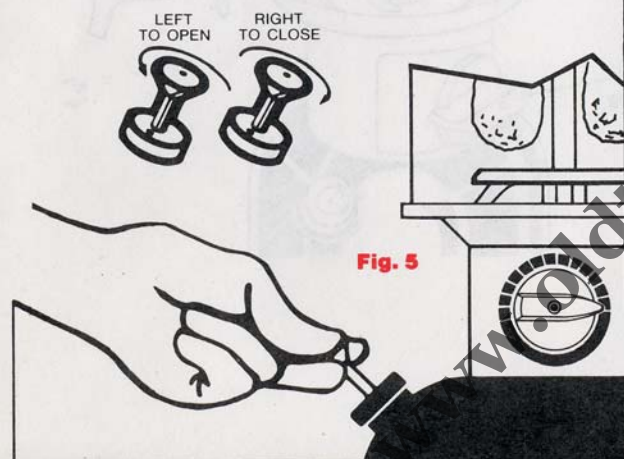

# 5

## To Light

1. Push lighted MATCH through lighting hole, hold near mantle and turn FUEL VALVE to "HIGH". Mantles will take a few seconds to light.

**CAUTION:** Flames other than at mantles indicate flooding or a leak. Turn FUEL VALVE "OFF", allow flames to burn out and lantern to cool. Carefully review instructions and correct problem before relighting lantern.

2. Open PUMP KNOB and pump 15-25 strokes. Close PUMP KNOB.
3. Adjust FUEL VALVE to desired brightness.
4. To clean tip, turn FUEL VALVE from "HIGH" to "OFF" to "HIGH" several times.
5. Additional pumping will be required at intervals. Good air pressure is important.

Fig. 6

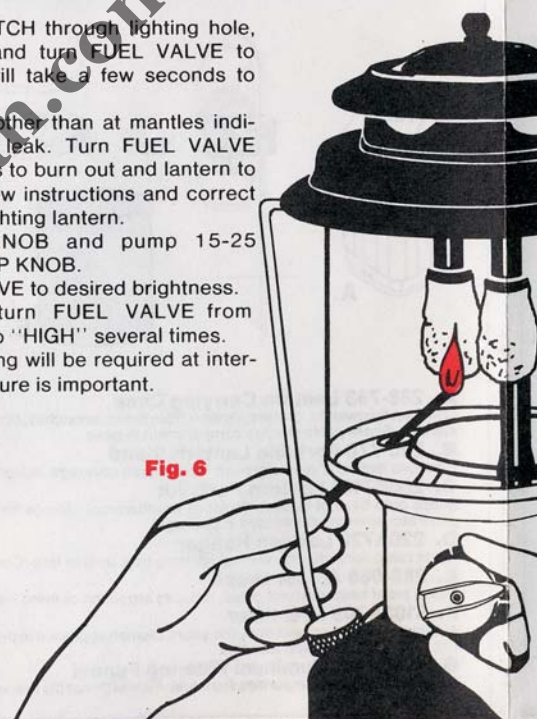

# 6

## To Turn Off

1. Turn FUEL VALVE to "OFF". Light will dim and go out in about 1-2 minutes.

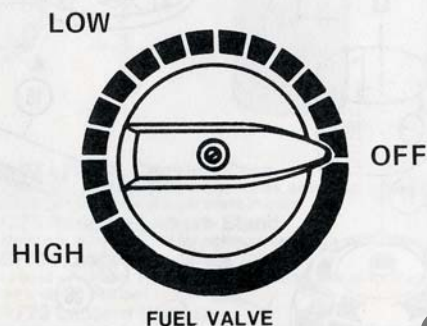

Fig. 7

## Things You Should Know

1. Carry a spare set of Coleman Mantles. Once burned, a mantle is fragile and can be damaged if touched or dropped.
2. For best results, use only Coleman fuel in this lantern. Coleman fuel is especially formulated and tested to rigid specifications with stabilizer additives for long storage life and a rust inhibitor to help prevent corrosion. Use of other fuels including unleaded automotive fuel may shorten generator life, damage lantern, and result in unsatisfactory performance.
3. Rinse tank occasionally with fresh fuel to remove sediment, gum formations, and moisture accumulations. If lantern is to be used for standby service, rinse and refill annually with fresh fuel.
4. Oil pump periodically to keep it working smoothly.
5. Part of the brightness control is located in the generator. If the lantern fails to adjust from High to Low properly, replace the generator.
6. The usual storage areas for camping and picnic equipment is the basement, attic, or garage. To avoid the accumulation of dust, cobwebs, etc. that is common in these storage areas, place your lantern in a plastic bag and seal it with a rubber band.
7. For repair service call 1-800-835-3278 TOLL FREE for location of your nearest Coleman Service Center. If lantern must be mailed to Service Center, attach your name, address, and a description of problem to product and mail to Service Center prepaid, less globe and ventilator to prevent breakage. If necessary to write the Service Center or factory, refer to your lantern as model 288.



## Parts List For Coleman Lantern model 288A700

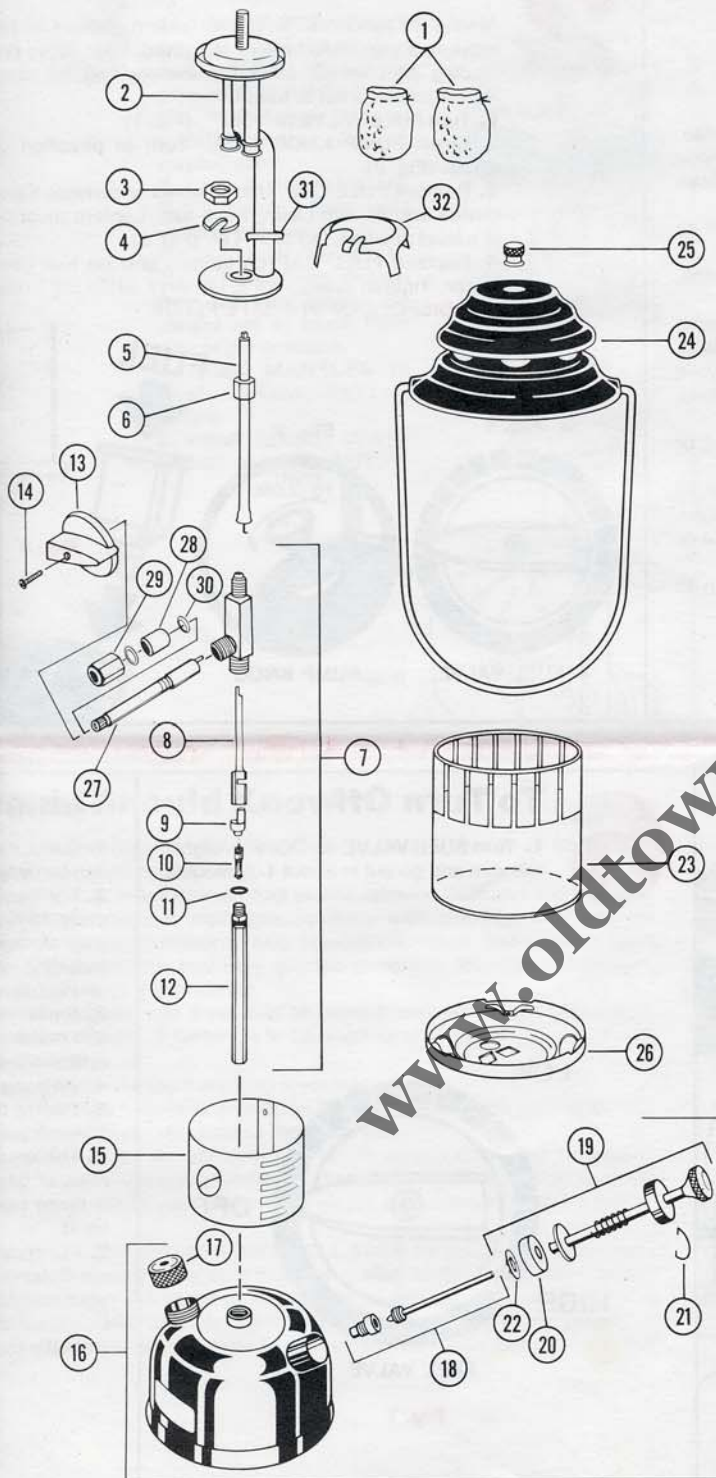

I.D. NO.	PART NO.	DESCRIPTION	I.D. NO.	PART NO.	DESCRIPTION
1	21A1001	Mantle	18	200-6381	Check Valve
2	288B5341	Burner Assy.			Stem Assy.
3	288-1641	Nut	19	242D5201	Plunger Assy.
4	288-1251	U-Clip	20	216-1091	Pump Cup
5	288-5891	Generator	21	530A5071	Pump Clip
6	288-1621	Jamb Nut	22	242-1071	Pump Cup Retainer
7	288A6571	Valve Assy.	23	288-0461	Globe
8	288C3041	Eccentric Block	24	288-5001	Ventilator & Bail Assy.
9	288B3031	Valve Block	25	288-441	Ball Nut
10	288-3651	Valve Core	26	288-5401	Frame Bottom
11	288-1261	O-Ring	27	288A6141	Valve Stem Ass'y
12	288B5231	Feed Tube Assy.	28	118D6201	Packing
13	288-5491	Knob	29	288-6161	Pack Nut
14	220C175	Screw	30	1202B1101	Pack Washer
15	288B5291	Collar	31	231A3111	Spring Clip
16	288-6161	Fount Assy.	32	288-1151	Heat Shield
17	220C1401	Fuel Cap			

## Coleman Lantern Accessories

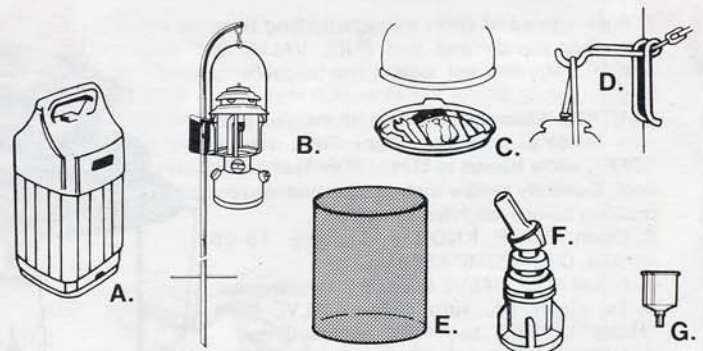

### A. 288-763 Lantern Carrying Case

Compact lightweight, protects lantern from dents, scratches, broken globes, adds to the life of mantles. Spare parts storage compartment in base.

### B. 220-770 Portable Lantern Stand

Positions lantern 5' above ground for optimum coverage. Adjustable reflector.

### C. 200B7101 Lantern Parts Kit

Provides weatherproof storage for mantles, pump lubricant and generator wrench (all included in package).

### D. 220A720 Lantern Hanger

Holds camp light securely without harming tree, post or limb. Complete with hanger and chain.

### E. 288-068 Amber Globe

Storm proof heat-resistant glass, reduces attraction of flying insects.

### F. 5103A703 Fuel Filler

Automatically and conveniently fills your Coleman appliance to proper level without guesswork. Fits Coleman one gallon fuel can.

### G. 199B1111 Aluminum Filtering Funnel

Removes dirt, water, impurities from fuel. Funnel throat fits precisely into Coleman appliances.