

www.oldtowncoleman.com

**How to Operate
and Service your**



INSTANT-LIGHTING

Model No. 426B

**THREE BURNER
CAMP STOVE**

▲
*To obtain satisfactory results,
read and follow these instructions carefully
step by step.*
▼

Made in United States of America

The Coleman Company, Inc.

General Office and Factory: WICHITA 1, KANSAS, U. S. A.
Canadian Office and Factory: Toronto, Canada

F1401 E

Litho in U. S. A.

COLEMAN CAMP STOVE 426B

PARTS LIST FOR COLEMAN CAMP STOVE No. 426B

| Part No. | DESCRIPTION |
|----------|---|
| 8B119 | ENAMEL (Pressurized Spray — Forest Green) |
| 17-058 | MACHINE SCREW (#4—36 x 1/4 Rd. Hd. Brass) |
| 118B1361 | GASKET (Filler Cap) |
| 200A5201 | PLUNGER ASSEMBLY (Pump) |
| 202-6491 | WHEEL (Valve) |
| 216-509 | LEATHER (Pump) |
| 220B1401 | FILLER CAP |
| 242-620 | PACKING (Valve Stem) |
| 242B532 | STEM (Air) |
| 242B5381 | CHECK VALVE |
| 387-6401 | BLOCK and NEEDLE ASSEMBLY |
| 387-6461 | TUBE ASSEMBLY (Fuel and Air) |
| 401-2181 | GAS TIP (Mk'd B) |
| 412-3531 | STEM (Lighter) |
| 412-5071 | CLIP (Pump Cap) |
| 413A2191 | COIL (Generator) |
| 413A251 | NEEDLE ASSEMBLY |
| 413A2621 | GENERATOR |
| 413C3021 | BURNER BOWL (Master) |
| 413C3061 | BURNER BOWL (Aux.) |
| 413C3451 | CAP and FILLERS (Master) |
| 413C3461 | CAP and FILLERS (Aux.) |
| 413C3601 | VALVE STEM (Aux.—with Manifold) |
| 420-4041 | LEG |
| 426-3231 | PIPE (Manifold) |
| 426-3261 | MASTER BURNER BODY |
| 426-4341 | GRATE |
| 426-6531 | STEM ASSEMBLY |
| 426-6601 | VALVE and GENERATOR (Complete) |
| 426B6551 | VALVE (Less Gen. and Valve Stem) |
| 426C1651 | TANK |
| 479-217 | PROTECTOR (Tip) |

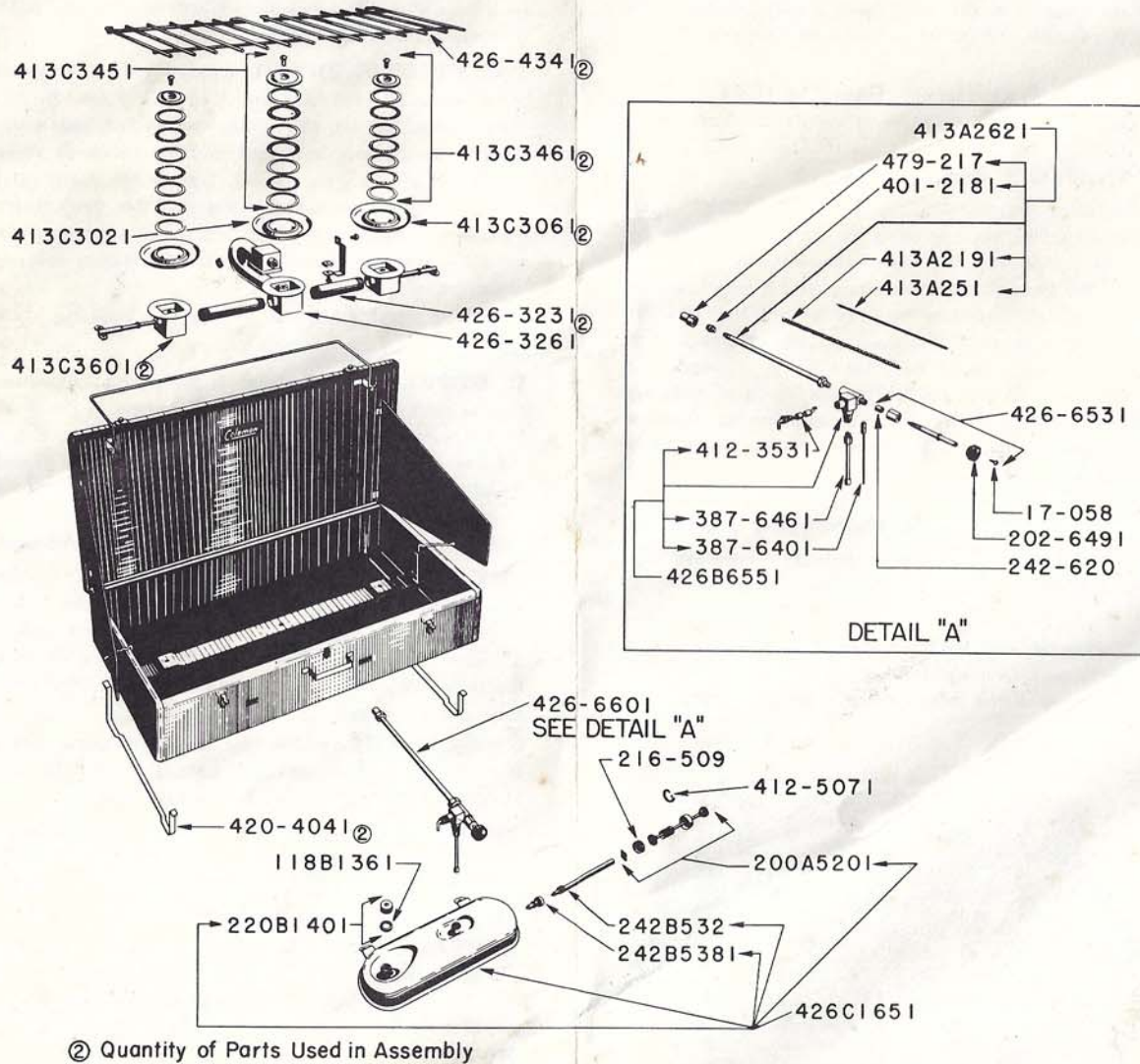

SEE YOUR COLEMAN DEALER FOR REPAIR PARTS

HOW TO USE YOUR 426B THREE BURNER CAMP STOVE

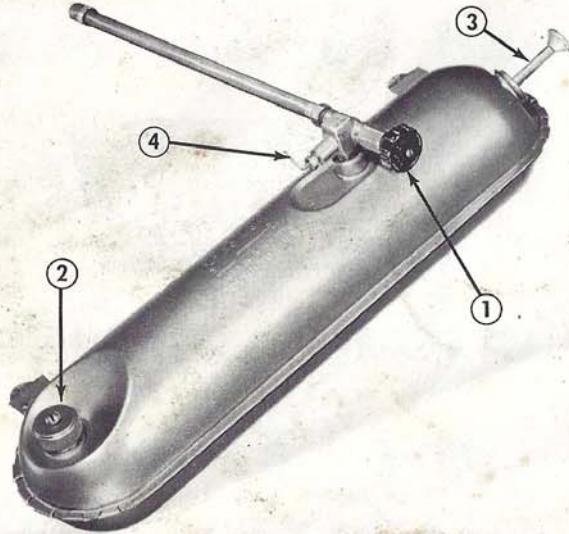

Always Use The Right Kind of Fuel

Those substances in gasoline which do not vaporize will collect in the generator in the form of carbon. The amount of service obtained from a generator depends therefore, to a great extent upon the kind of fuel used.

If available use a clean, fresh, unleaded gasoline. Never use a gasoline containing lead compounds or lubricating oils. Keep gasoline supply in a small clean, closed metal can. Do not use a glass container because of hazard in case of breakage.

If a suitable unleaded fuel is not available then ask your service station operator to inquire of, or write to his company. Most oil companies make available a special stove and lighting fuel or naphtha for use in those localities where a suitable white gasoline is not available.

To Open Stove

Pull the supporting legs down until they snap into place. Open the lid to a level position with the stove by letting the rod bracket support it. If the wind is blowing to the extent that the burners need protection, then support the lid in an upright position by running the wire support rods at the ends of the camp stove through the holes in the wind baffles. Raise the grate and lift out the tank assembly.

To Fill Tank

Be sure generator valve (1) is closed tightly by turning valve wheel to the right. Unscrew filler cap (2). Have tank in a level position while filling it with clean, fresh fuel. The tank will hold approximately three and one-half pints. Replace filler plug and tighten firmly with fingers.

To Pump Air Pressure Into Tank

Be sure that the generator valve (1) and the filler plug (2) are closed firmly. Turn pump plunger handle (3) approximately two complete turns to the left. Place thumb over small hole in pump plunger handle and pump 35 to 50 full strokes of air into tank. Now turn the pump plunger handle to right and tighten firmly.

To Place Tank And Generator Unit In Operating Position

Insert the generator into large hole above the carrying handle, then into opening in mixing chamber. Engage the hanger brackets into slots in front of case to support the tank.

To Instant-Lite Master Burner

Be sure both auxiliary valves are closed. Controls are at each end of the case. Turn the instant lighting lever (4) on valve body to "UP TO LIGHT" position. While holding a lighted match above master burner open generator valve by turning valve wheel (1) as far as it will go. When burner lights close generator valve stem until you have the flame under control. Maintain a strong active flame on the burner for approximately one minute. At that time the flame on the burner should be quite blue, so turn the instant lighting lever (4) to "DOWN TO BURN" position. Flame regulation is obtained by turning valve wheel (1) to the right or left. Increasing the air pressure in the tank will increase the force or efficiency of the flame.

To Light Auxiliary Burners

After the main burner has been lighted, either or both of the auxiliary burners may be lighted by opening the auxiliary valves while holding a lighted match above the auxiliary burner. You may adjust the flame on either of the auxiliary burners to any desired height by turning the auxiliary valve to the right or left. Changing the height of

the flame on the auxiliary burners will affect the flame on the master burner to the extent that it may be necessary to again regulate the flame on the master burner.

To Turn Auxiliary Burner Off

Turn the auxiliary burner valve to right until closed.

To Shut Off Main Burner

Turn the instant lighting lever (4) to "UP TO LIGHT" position and allow the stove to burn for about one minute on the instant gas mixture. This clears the heavier parts of the fuel from the generator and makes possible better instant lighting results the next time the stove is used. Now turn the generator valve wheel (1) to the right and tighten firmly. The valve stem seats in the valve body to provide a positive shut off at that point. The few drops of gasoline trapped in the generator tube will continue to vaporize and may produce enough gas to carry on the flame for a minute or so.

To Pack Stove Into Carrying Position

Reverse the procedure followed in setting up the stove. The tank and generator assembly should be placed in the left end of the stove as you stand in front of it.

After locking lid in place, lay stove down with bottom side up. Push in on both ends of the stove leg at the same time in order to unlock the legs; then you can push them back into the frame.

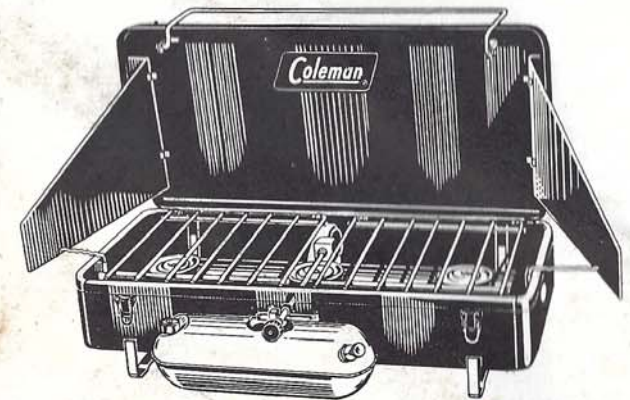

GENERAL SUGGESTIONS

KEEP BURNER PARTS clean. An obstruction, such as a burned match head, near fillers in cap, will produce a yellow flame at that point.

THE PUMP PLUNGER is not only used for pumping air pressure into the tank but it acts as a wrench to turn the air stem. Turning the plunger to the left, unscrews the air stem so air may be forced through the check valve at the bottom of the pump barrel. Turning the pump plunger to the right, screws the air stem into the check valve to provide a positive shut off at that point. Air pressure may be added while stove is burning. Oil the leather occasionally for greater efficiency.

KEEP TANK CLEAN by rinsing it occasionally with clean fuel.

IF STOVE IS to be stored for any length of time, be sure to empty the tank to prevent any acid in the gasoline from damaging tank. Remove filler cap and you can pour the gasoline out through the filler cap bushing. Gasoline, if left in the tank for a long time, might sour and produce a gum or varnish-like substance which would interfere with correct operation of the instant-lighting mechanism.

THE STOVE GENERATOR is merely a device for vaporizing or changing the liquid fuel to a vapor. Eventually the generator may fill up with carbon to the extent that no more fuel may be forced through it. It would be well, therefore, to keep an extra generator, No. 413A2621, on hand for a spare.

THE GASKET in filler cap may deteriorate with age. It might be well to install a new, No. 118B1361 gasket every year or so if the old one is hard and brittle.

AFTER EACH CAMPING trip be as careful about cleaning tank and other parts of your Camp Stove as you are about cleaning your fishing tackle or gun and your Coleman Camp Stove will render you faithful service.

CONTACT YOUR DEALER when you need service assistance or parts for your stove. If necessary to write The Coleman Company, Inc., mention that the stove is a No. 426 B.

NOTICE:

The use of any attachment or device that is not expressly approved by The Coleman Company, Inc., to alter or affect the operation of the appliance automatically cancels all warranties, implied or expressed. Furthermore, the Company shall not be liable for any consequences that result from the use of equipment under these circumstances.