



How to Use and Enjoy Your
Sportster II Stove
Model 508-700



Limited 1 Year Warranty

This product is warranted to the retail consumer for one year from date of retail purchase against defects in material and workmanship and is transferable. If a Customer information Card is enclosed please return it so that we may reach you in the unlikely event that a safety recall is needed. Return is not required to validate this warranty.

WHAT IS COVERED: Replacement parts and labor. Transportation charges to Consumer for repaired Product.

WHAT IS NOT COVERED: Transportation charges to Coleman for defective Product. Damages caused by abuse or failure to perform normal maintenance — see owner's manual. Sales outside of the United States. Any other expense. **Consequential damages, incidental damages, or incidental expenses, including damage to property.** Some states do not allow the exclusion or limitation of incidental or consequential damages, so the above limitation or exclusion may not apply to you.

HOW TO OBTAIN WARRANTY PERFORMANCE: Locate nearest Coleman Service Center by calling 1/800/835-3278 TOLL FREE! Attach to Product your name, address, description of problem, phone number and proof of date of retail purchase (sales slip). Package and return Product to Coleman Service Center, *transportation charges prepaid*.

IMPLIED WARRANTIES: Any implied warranties, including the implied warranties of merchantability and fitness for a particular purpose, are limited in duration to one year from date of retail purchase. Some states do not allow limitations on how long an implied warranty lasts, so the above limitation may not apply to you.

To the extent any provision of this warranty is prohibited by federal, state or municipal law which cannot be preempted, such provision shall not be applicable. This warranty gives you specific legal rights, and you may also have other rights which vary from state to state.

THE COLEMAN COMPANY, INC. 3600 N. Hydraulic, Wichita, Kansas 67219

Made in United States of America

THE COLEMAN COMPANY, INC.

General Office and Factory: Wichita, Kansas U.S.A. 67201

Canadian Office and Factory: Toronto, Canada

1960B397 (10-86) P.I.

LITHO IN U.S.A.

Parts List for Coleman Sportster II Stove Model 508-700

I.D. NO.	PART NO.	DESCRIPTION
1	508-6151	Fount
2	220C1401	Filler Cap
3	508-5571	Valve Assembly
4	413D3021	Burner Bowl
5	400-3451	Burner Ring Set
6	1147B1012	Screw, Burner Cap
7	216-1091	Pump Cup
8	242D5201	Pump Plunger
9	200-6381	Air Stem & Check Valve
10	530A5071	Clip for Pump Cap
11	400-5261	Burner Box Assembly
12	400-0601	Screw (Pkg. of 6)
13	400-1261	Generator Bracket
14	400-5401	Grate
15	508-5891	Generator & Regulator Assembly
16	508-1601	Wrench
17	508-7631	Carry Case

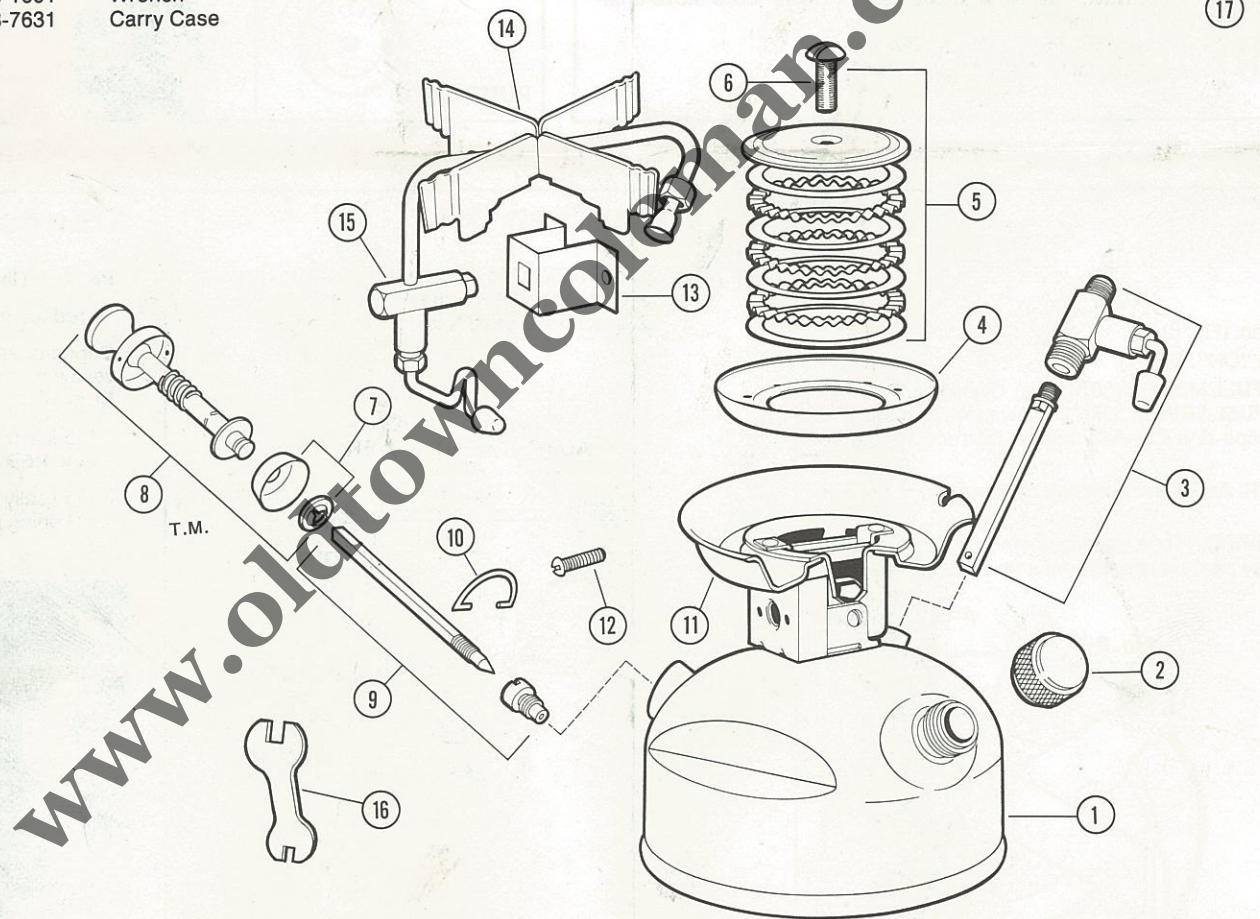

Principles of Operation

The stove consists of four main components: The **TANK**, **PUMP**, **FUEL VALVE** and **GENERATOR**.

The **TANK** is designed to hold both the fuel and air. To avoid a fuel leak during lighting, an adequate air space **MUST** exist above the fuel level in the tank. Never overfill tank as this will decrease the needed air space. To avoid overfilling, **ALWAYS** fill stove on a level surface. Never tip stove on its side in an attempt to pour extra fuel in the tank.

The **PUMP** pressurizes the fuel tank. Opening the pump knob one turn allows air to be pumped past a check valve and into the air space above the fuel.

The **FUEL VALVE** controls the flow of fuel and air from the tank to the generator. This valve has two positions: "OFF", and "ON". The "OFF" position closes the fuel valve and prevents fuel flow. In the "ON" position, fuel flows through the valve to the generator where it is heated and vaporized before reaching the burner. When the stove is first lighted, both fuel and air from the tank pass through the fuel valve. As soon as the stove lights, it is important that additional air be pumped into the tank to replace the air that is passing through the fuel valve. Pump for at least ONE FULL MINUTE. Time your pumping so that you pump one stroke per second or about 60 strokes per minute.

The function of the **GENERATOR** is to absorb heat from the burner and vaporize the liquid fuel passing through the generator. Attached to the end of the generator is the flame adjustment mechanism. Moving the flame adjustment lever from "CLEAN" to "LIGHT/HI" moves a needle in and out of a small orifice in the end of the generator. The needle both cleans the orifice and regulates the flow of fuel. Always light the stove with the flame adjustment lever in the "LIGHT/HI" position so that the stove is delivering full heat output to the generator.

If you notice an intermittent yellow flame when operating at a low heat setting, move the flame adjustment lever to a slightly higher setting. This will increase the heat on the generator and eliminate the yellow flame.

The fuel valve lever and the flame adjustment lever pass through packing nuts into the valve bodies. Behind each packing nut is a packing, or gasket material. The purpose of the packings are to put tension on the levers so they don't move too easily and also to prevent fuel from leaking around the levers. If the levers loosen up from use or if a fuel leak should occur, tighten the packing nuts approximately one half turn.

Other Coleman Stove Accessories

A. 5103-703 Fuel Filler

Automatically and conveniently fills your Coleman appliance to proper level without guesswork. Fits Coleman one gallon fuel can.

B. 199B1111 Aluminum Filtering Funnel

Removes dirt, water, impurities from fuel. Funnel throat fits precisely into Coleman appliances.

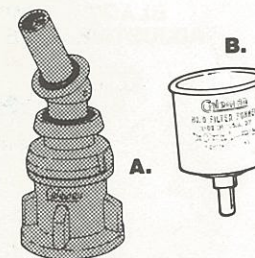

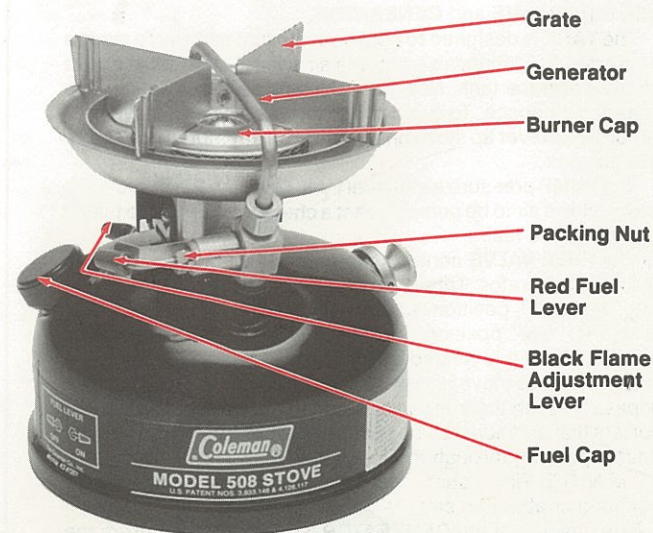

1 Follow Instructions and Warnings To Avoid Possible Injury Or Property Damage. WARNING:

1. This stove consumes air (oxygen). Do not use in unventilated or enclosed areas to avoid endangering your life.
2. Fuel for your stove is extremely flammable. Use the same care as when using gasoline.
3. This stove is designed to use Coleman Fuel. Never use kerosene, regular or premium leaded automotive fuel.
4. Store fuel in a clean, properly marked, metal container. Use and store away from flame (including pilot lights) or excessive heat.
5. Always fill outdoors. Never fill tank, loosen or remove fuel cap while stove is near flame, other heat sources or while stove is hot to the touch.
6. Always light and use stove outdoors; never inside house, camper, tent, or other enclosed areas.
7. Never allow tents, sleeping bags, clothing or any flammable material to come within three feet of the top and one foot of all sides of the stove.
8. When stove is in use, all metal parts of burner assembly and controls become extremely hot. DO NOT TOUCH.
9. Never place heavy or large capacity utensils on stove. Never alter stove in any way or use with any device or part not expressly approved by Coleman. Never use as a space heater. Never leave stove unattended while burning.
10. Never pump the stove while a utensil is on it.
11. Keep out of reach of children.

2 To Fill Tank

1. NEVER FILL OR LIGHT STOVE INSIDE HOUSE, CAMPER, OR TENT.
2. Place stove on a smooth, level surface.
3. Move the **RED FUEL LEVER** to the OFF position. (Fig. 1)
4. Close **PUMP KNOB** firmly. Turn in direction of arrow on pump knob. (Fig. 2)
5. Remove **FUEL CAP**. Use a funnel or suitable filling device and fill with clean, fresh fuel. DO NOT TIP STOVE. (Fig. 3)
6. Replace **FUEL CAP** on stove and on fuel container. Tighten firmly. Move fuel container away from stove Wipe UP ANY SPILLED FUEL AND DISPOSE OF IN A SAFE PLACE.

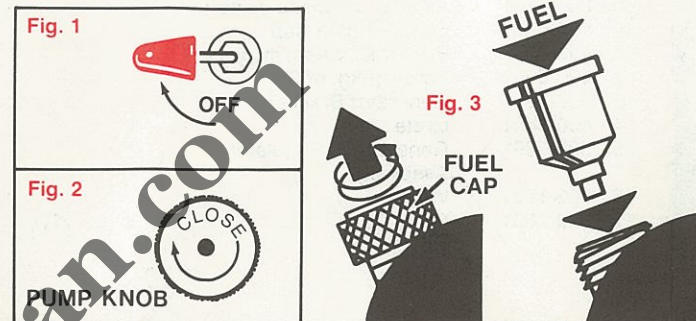

3 To Pump

1. Make sure **RED FUEL LEVER** is in the OFF position. (Fig. 4)
2. Open **PUMP KNOB** one turn.
3. With thumb over hole in **PUMP KNOB**, pump approximately 25 full strokes.
4. Close **PUMP KNOB** firmly.

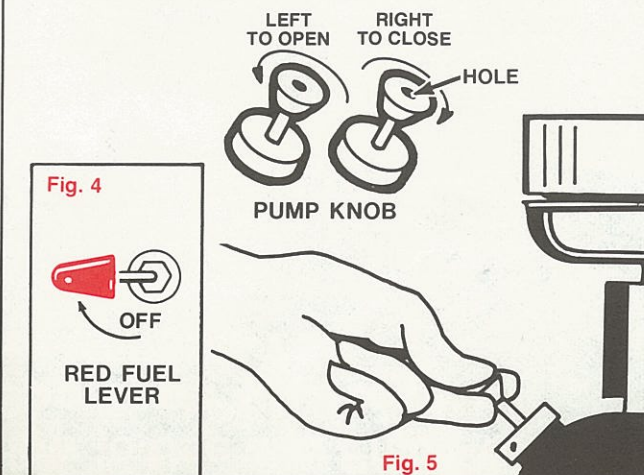

4 To Light

For Temperatures below freezing, see note below.

1. Place stove on a smooth, LEVEL surface.
2. Move **BLACK FLAME ADJUSTMENT LEVER** to the "LIGHT/HI" position. (Fig. 6)
3. First hold lighted match at burner and THEN turn **RED FUEL LEVER** to "ON". (Fig. 7)
4. As soon as burner lights, open **PUMP KNOB** one turn and pump for ONE FULL MINUTE (60 pumps). Close **PUMP KNOB**. CAUTION: If fuel or flames appear below burner, immediately turn **RED FUEL LEVER** "OFF". Allow stove to cool. Turn stove upside down to empty any fuel that accumulated in the burner. Wipe dry. Carefully review instructions before relighting stove.
5. Adjust flame to desired heat with **BLACK FLAME ADJUSTMENT LEVER**. Additional pumping may be required for full heat output.

NOTE: IN TEMPERATURES BELOW FREEZING PREHEATING IS REQUIRED. Place generous amount of preheating paste on burner cap beneath the generator (Fig. 8). Light the paste. After the paste is almost consumed, follow the above lighting instructions.

BLACK FLAME ADJUSTMENT LEVER

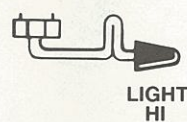
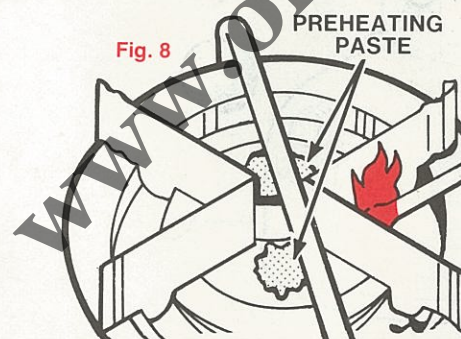

Fig. 6

Fig. 7



ON RED FUEL LEVER



To Turn Off

1. Move **BLACK LEVER** from CLEAN to HI several times. Leave lever in HI position. (Fig. 9)
2. Latch **RED LEVER** in OFF position. (Fig. 10)

Fig. 9

BLACK FLAME ADJUSTMENT LEVER

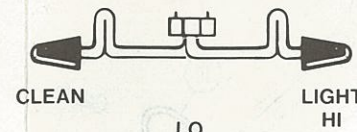

RED FUEL LEVER



Fig. 10

Things You Should Know

- **PREHEATING PASTE** is available at most stores that sell backpacking equipment.
- To reduce the possibility of rust and corrosion, flush tank and refill frequently with fresh fuel.
- During operation for an extended period at a low heat setting, you may notice an intermittent yellow flame. This can be corrected by adjusting the flame to a slightly higher level with the **BLACK LEVER**.
- Periodically check the tightness of the packings and if necessary, tighten the **PACKING NUTS** on the **RED** and **BLACK LEVERS** just enough to prevent leaks.
- Periodically squirt a few drops of oil into the oil hole in the **PUMP CAP**. This will keep the pump functioning properly.

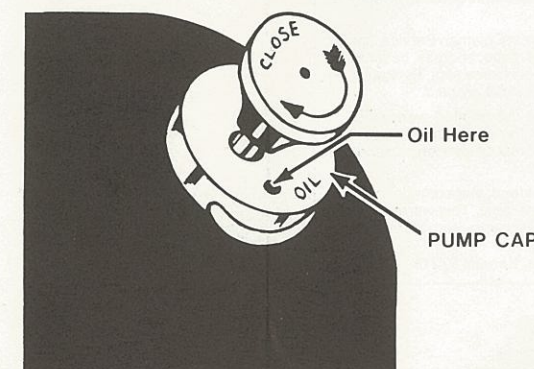

IMPORTANT

After burning the first tank of fuel through your stove, use the enclosed wrench to tighten the **PACKING NUT** $\frac{1}{2}$ turn. This will prevent a possible fuel leak through the **PACKING NUT**.

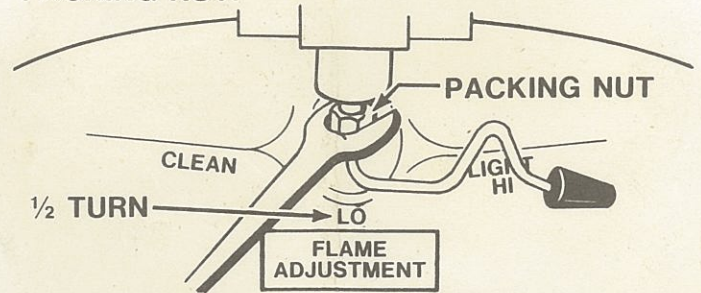

The **PACKING NUT** should need no further tightening, but it's a good idea to look for fuel leaks during each use. If a leak should occur, tighten the **PACKING NUT** just enough to stop the leak.

1960-453

NOTICE

Step 5 under Lighting instructions is very important. After burner lights be sure to pump at least **ONE FULL MINUTE** (60 pumps)