

1 How to Use and Enjoy Your Coleman Heater

CAUTION:

This appliance consumes oxygen and emits products of combustion. When used in any enclosed space, provide two fresh air openings (preferably one high and one low, and on opposite walls) of at least 38.7 cm² (6 square inches) each. Increase fresh air openings as marked on each additional appliance. Never use in an unventilated enclosed area.

Do not leave appliance operating if an adult is not in attendance.

Do not allow anyone who has not read the operating instructions to operate or handle the appliance in any way.

Do not allow children to approach or operate heater.

Warning: Minimum clearances from combustibles:
(measured from reflector rim)

Sides and Rear: 22.9 cm (9")
Front and Top: 91.4 cm (36")
Floor: 76.2 cm (30")

1. Read all instructions thoroughly before operating appliance.
2. Never remove or loosen filler cap while heater is hot, near an open flame, or other sources of ignition.
3. Do not leave heater unattended while operating.
4. Always fill and light out of doors, away from open flame, combustibles and heat.
5. Use only Coleman fuel (or naphtha camping fuel marked as suitable for use with catalytic heaters). Never use automotive fuel, leaded or unleaded.
6. Store fuel away from open flame or excessive heat.
7. Do not use a spark lighter when lighting, as they do not always provide positive ignition. Always use a lighted taper or match to ensure proper ignition.
8. Allow adequate clearances from combustible materials (tent, ceilings, walls, clothing, sleeping bags, etc., as noted on appliance label).
9. Ensure that heater is situated on a level stable surface at least 61 cm (24") off the floor and that combustible materials cannot be inadvertently dropped over the top or near the front of the reflector bowl.
10. To avoid burns when heater is hot, handle only by the bail handle and the tank.
11. When heater is operating or in storage, ensure that handle is down and resting against the fuel tank.
12. For your safety and convenience, ensure that heater is maintained in good operating condition. Worn, damaged or defective parts should be corrected or replaced immediately. Shut down and do not use if abnormal performance becomes evident. The heater can be tested and repaired at your nearest Coleman Service Centre.

2 To Fill Tank

1. Turn control knob to OFF. (Maximum clockwise position). (Fig. 1).
2. Providing all flames have been extinguished and all parts of the heater are cool to the touch, unscrew filler cap. (Fig. 2)
3. Place heater in level position, and using Coleman funnel or "Easi-Fill" fill with Coleman fuel. (Fig. 3)
DO NOT TIP – overfilling will cause heater to flare up on lighting.
4. Replace filler cap, finger tight.
5. Wipe off any spilled fuel.
NOTE: Never loosen or remove filler cap while heater is operating, or near other heat sources.



3 To Pump

1. Ensure control knob is in "OFF" position (Fig. 4) and filler cap is firmly closed.
2. Test Pump - With pump knob in closed position (turn right), place thumb over hole in pump knob (Fig. 5) and pump. If little or no resistance is felt, lubricate pump with a few drops of light oil, or replace pump leather. (See "To Replace Pump Leather"). If pump resists, proceed to Step 3.
3. Open pump knob by turning two (2) turns to left.
4. With thumb over hole in pump knob, pump 30 or more strokes of air into tank. (Fig. 5)
If tank is not full of fuel, more strokes will be required.
5. Close pump knob by turning to right until tight.



Fig. 4

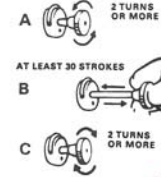

Fig. 5

4 To Light

1. Ensure control knob is in "OFF" position.
2. Ensure heater is pumped up.
3. Do not lean over heater while lighting.
4. Insert lighted match through hole in rear of reflector bowl and hold flame against the burner screen (Fig. 6). Turn control knob counter clockwise "CLIC" to the "LITE" position. Do not turn past the "LITE" position. (Fig. 7).
5. After several seconds, burner will light and burn with a yellow flame. Continue to hold flame of match against burner screen to ensure ignition.
NOTE: Should heater fail to light or match go out before ignition, turn control knob to the "OFF" position (Fig. 8) and repeat above procedure.
6. Approximately 20 to 30 seconds after ignition, the yellow flame will subside and the screen will glow bright red. When this happens, turn control knob to the desired heat setting "HI-LOW", (Fig. 9). If, however, it should flare up with high yellow flames, shut off and wait until flames have died out. Allow heater to stand for five minutes and repeat lighting procedure.
7. After heater has been lit and operating for one or two minutes, and if the flame seems lazy when at "HI", turn knob quickly to OFF and back to HI again a few times. This will clean the jet. Also repump as necessary.
8. If you make a mistake when lighting – e.g. forget to shut valve off before pumping prior to lighting – you will get a flooding condition – i.e. fuel will drip from the burner onto the bottom of the reflector bowl. In this case, shut off the valve, wipe off liquid fuel from bottom of reflector bowl, and then light burner without turning on valve. After flames are nearly burned out of burner, turn valve to the HI position.
9. When operating or turning the control knob to low position, check burner to ensure outage has not occurred. Do not set to a position in which less than half of the burner screen is red.
10. Ensure handle is in down position.



Fig. 6

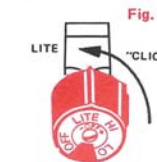

Fig. 7

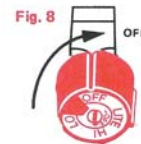

Fig. 8

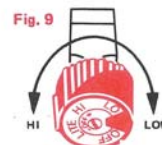

Fig. 9

5 To Shut off

Turn control knob fully clockwise to the "OFF" position (Fig. 10).

NOTE: Heater may burn slightly for a few minutes until fuel empties from generator.



6 To Transport and Store

1. Allow heater to cool completely after extinguishing. Open filler cap for a few minutes to relieve tank pressure and retighten.
2. Transport and store in upright position with bail down, in a cool, safe place.

When temperatures are below freezing, it is necessary to preheat the burner and generator. This can be accomplished in two ways (after filling and pumping) by:

1. Pour two tablespoons of alcohol (methyl hydrate) on the burner screen. Some will run down into the pocket in the bottom of the reflector bowl. Light the alcohol and when nearly burnt out, turn burner to HI. If excessive flame is evident, shut off and repeat the preheating procedure.
2. If you have no alcohol, the heater can be primed by turning on the valve to HI until fuel begins to drip from the burner onto bottom of reflector. Shut off valve. Wipe off the fuel on the bottom of the reflector and then light burner, but leave control in the OFF position. When flames on the burner are almost out, turn to HI.

To Replace Pump Leather

If pump offers little or no resistance during test, (see - TO PUMP) and oiling does not correct the problem, replace the pump leather.

1. Empty tank of fuel.
2. Remove pump cap clip and pull out pump plunger assembly.
3. Remove nut from end of plunger.
4. Replace pump leather.
5. Push nut onto plunger.
6. Work several drops of oil into new pump leather until soft and pliable.
7. Re-insert air stem into plunger and place pump plunger assembly into tank. Be careful that pump leather does not fold, crimp or invert when being inserted in tube.
8. Replace clip.

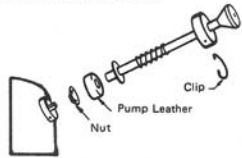

Care of Reflector Bowl

If for any reason the reflector bowl has become sooted - e.g. due to flooding from improper lighting - it can be cleaned to restore its heat reflecting efficiency as follows:

Remove outer protective wire guard, first noting its orientation and also the orientation of the burner. Wash inside of bowl with a soft damp, soapy cloth. If this fails to remove the black carbon, a mild non-scratching scouring powder will normally do the job. Replace burner guard and position it and the burner to the original orientation (radial members of the guard appear as an X and the holes in the side of burner metal cup are positioned horizontally). Take care that the square bracket on the inside of the bezel on the guard slides over the sides of burner box, thus avoiding excessive force on installation.

La garantie Coleman sur les pièces de réparation est rendue nulle et non avenue par l'emploi de pièces de rechange autres que les pièces Coleman authentiques. Recherchez toujours cette marque.

L'équipement dans ces circonstances.

La garantie Coleman sur les pièces de réparation est rendue nulle et non avenue par l'emploi de pièces de rechange autres que les pièces Coleman authentiques. Recherchez toujours cette marque.

AVIS: L'emploi de tout accessoire ou dispositif qui n'est pas expressément approuvé par The Canadian Coleman Company Limited en vue de modifier ou d'affecter le fonctionnement de l'appareil, abroge automatiquement toute garantie Coleman au pays, à l'usine Coleman, ou au centre de service sous garantie Coleman autorisé le plus proche de chez vous.

Cette garantie ne s'applique pas, bien entendu, aux génératrices des poêles et lanternes, ni à tout produit qui présente des signes évidents que les dommages ont résulté d'une manipulation ou d'un fonctionnement incorrect.

Toute composante s'éverant détériorée par suite d'une imperfection des matières premières ou de la main-d'œuvre sera remplacée gratuite-ment si elle est retournée, port payé, à l'usine Coleman, ou au centre de service sous garantie Coleman autorisé le plus proche de chez vous.

Tous les nouveaux modèles d'articles de camping Coleman sont garantis pour un an contre les défauts de matière premières ou de main-d'œuvre.

VOTRE GARANTIE COLEMAN

La garantie Coleman sur les pièces de réparation est rendue nulle et non avenue par l'emploi de pièces de rechange autres que les pièces Coleman authentiques. Recherchez toujours cette marque.

NOTICE: The use of any attachment or device that is not expressly approved by The Canadian Coleman Company Limited, to alter or affect the operation of the appliance automatically cancels all warranties, conditions or expressed, the Company shall not be liable for any consequences that result from the use of equipment under these circumstances.

La garantie Coleman sur les pièces de réparation est rendue nulle et non avenue par l'emploi de pièces de rechange autres que les pièces Coleman authentiques. Recherchez toujours cette marque.

Any part found defective because of imperfect material or workmanship will be replaced without charge when returned with transportation charges prepaid to the Coleman factory, or to the nearest Coleman authorized in-warranty service station.

This guarantee does not, of course, apply to generators or stoves and lanterns, nor to any product where it is evident that damage has developed from improper handling or operation.

Any part found defective because of imperfect material or workmanship will be replaced without charge when returned with transportation charges prepaid to the Coleman factory, or to the nearest Coleman authorized in-warranty service station.

This guarantee does not, of course, apply to generators or stoves and lanterns, nor to any product where it is evident that damage has developed from improper handling or operation.

La garantie Coleman sur les pièces de réparation est rendue nulle et non avenue par l'emploi de pièces de rechange autres que les pièces Coleman authentiques. Recherchez toujours cette marque.

YOUR COLEMAN GUARANTEE

Sachez bien profiter de votre radiateur à rayonnement



How to Use and Enjoy Your Radiant Heater

EASI-LITE®

model / modèle
519-499



The Canadian Coleman Co., Ltd.
700 Kipling Avenue
Toronto, Ontario MBZ 5V6

