

THE COLEMAN COMPANY, INC.
General Office and Factory: Wichita, Kansas U.S.A. 67201
Canadian Office and Factory: Toronto, Canada

Made in Canada by The Canadian Coleman Co., Ltd.

THE COLEMAN COMPANY, INC. 3600 N. Hydraulic Wichita, Kansas 67219

Peak 1 apparel products constructed of Gor-Tex® fabrics will provide many years of service if properly cared for. However, the useful life of these materials is not yet known. Therefore Peak 1 warrants these materials against leakage for three years from the date of purchase. All such garments must be thoroughly laundered prior to seeking warranty service.

This warranty gives you specific legal rights, and you may also have other rights which vary from state to state.

How to obtain warranty performance: Return the product, with sales receipt, to place of purchase, or ship it (prepaid) to your nearest authorized Peak 1 Service Center (to locate your nearest Service Center write to: Peak 1 Repairs, Dept. #678, P.O. Box 1762, Wichita, KS 67201). Collect shipments cannot be accepted.

WHO RECEIVES WARRANTY: Original owners in the United States or through U.S. Military exchange systems.

WHAT IS NOT COVERED: Repair due to normal wear, accident, improper use, improper care and maintenance, or negligence where we are not at fault. Repairs of this nature will be performed for a reasonable charge.

WHAT IS COVERED: Repair (parts and labor) or replacement, at our option, required because of defective material or workmanship.

All Peak 1 products are fully warranted to the original owner against defects in materials and workmanship, except as qualified below. If a product fails due to a manufacturing or material defect, we will repair the product without charge, or replace it, at our option.

Our philosophy is that no product is really sold until it is delivering satisfactory service to you, the user. Accordingly, we strive for an exceptional level of quality in every product we build. As part of our commitment to excellence, we are proud to offer this outstanding warranty.

Peak 1 Full Warranty



How to Use and Enjoy Your Multi-Fuel Backpack Stove Model 550-499

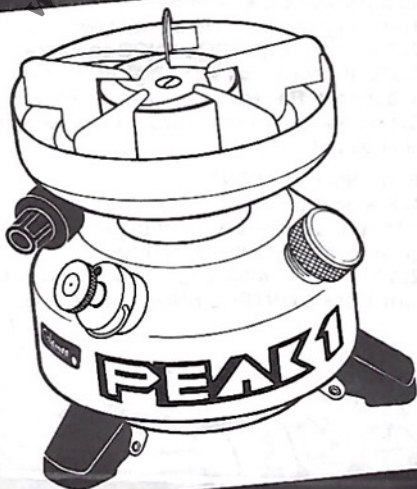

PEAK 1

Parts List for Coleman Peak 1 Multi-Fuel Backpack Stove Model 550-499

Item	Part No.	Description
1	550-8321	Screw
2	550-3655	Grate
3	550-3751	Burner
4	550-4615	Insulation
5	550-4605	Heat Shield
6	216-5095	Pump Cup
7	505-5205	Pump Plunger Complete
8	222-5361	Air Stem & Check
9	550-1405	Filler Cap
10	530A5071	Pump Cap Clip
11	550-4895	Collar
12	550-2891	Generator Complete (Gas)
13	321C6011	Spring Clip
14	550A6491	Knob & Screw
15	550-6565	Valve Assembly (Gas)
16	550-3001	Leg, Ring & Rivet
17	550-1595	Tank
18	550-2901	Generator Complete (Kerosene)
19	550-6555	Valve Assembly (Kerosene)
20	5410-1341	'O' Ring (set of 2)

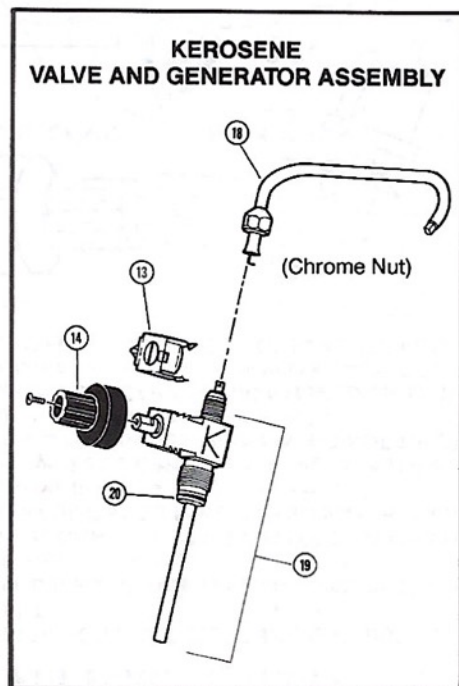
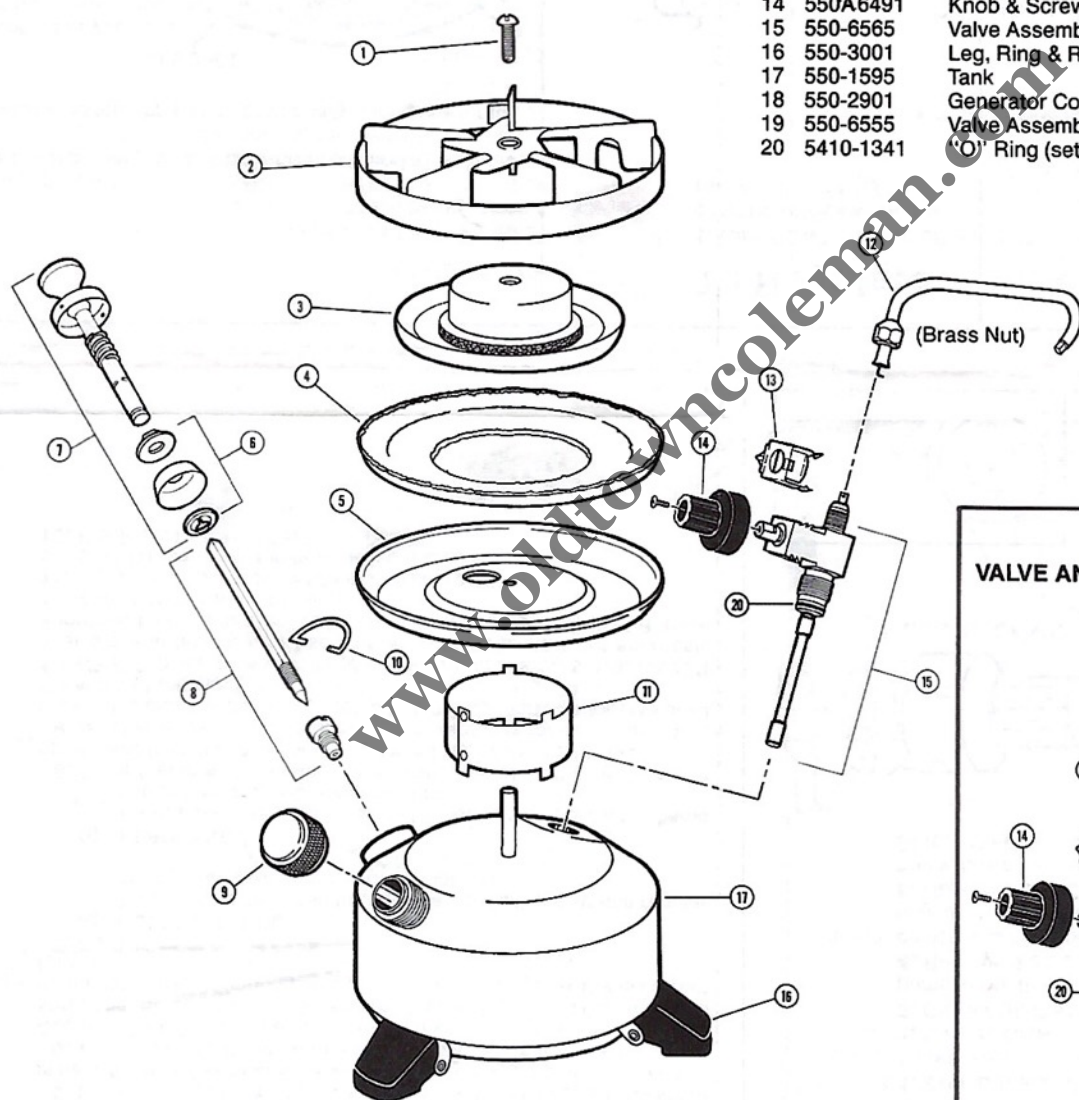

TO CONVERT STOVE FROM COLEMAN FUEL TO KEROSENE:

The kerosene valve and generator can be identified by the letter "K" stamped into the side of the valve and by the chrome nut on the generator. The Coleman fuel valve has no letter stamped into it. The Coleman fuel generator has a brass nut.

TO REMOVE VALVE AND GENERATOR ASSEMBLY

1. Move away from any ignition source.
2. Release any pressure from tank by loosening filler cap and then retightening.
3. Hold valve and loosen generator nut ($\frac{7}{16}$ " wrench) two full turns.
4. Remove screw from top of burner and lift off the grate.
5. Swivel generator away from burner.
6. Lift off burner, insulation, heat shield, and collar.
7. Retighten generator nut.
8. Remove control knob screw and control knob from valve.
9. Unscrew valve and generator assembly from tank.

TO INSTALL VALVE AND GENERATOR ASSEMBLY

1. Lubricate "O" ring on valve with oil.
2. Screw valve and generator assembly into tank, finger tighten, and then unscrew the assembly only enough to position the valve in its proper position.
3. Replace control knob and secure with screw.
4. Loosen generator nut two full turns.
5. Replace collar, heat shield, insulation, and burner.
6. Swivel generator towards burner and insert end of generator into burner opening.
7. Replace grate and tighten top burner screw. Be sure the generator fits in the notch in one of the grate baffles.
8. Hold valve and tighten generator nut firmly.
9. Visually check for leaks immediately after lighting.



1

Follow Instructions and Warnings To Avoid Possible Injury Or Property Damage.

WARNING:

1. This stove consumes air (oxygen). Do not use in unventilated or enclosed areas to avoid endangering your life.
2. When stove is in use, all metal parts of the burner assembly and controls, become extremely hot. **DO NOT TOUCH.**

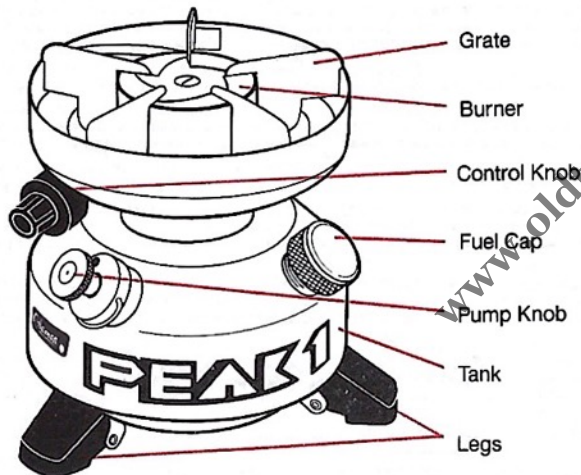

3. Fuel for your stove is extremely flammable. Use the same care as if you were using gasoline.

4. Always light and use stove outdoors; never inside house, camper, tent, or other enclosed areas.

5. Fill outdoors. Never fill tank, loosen or remove fuel cap while stove is near flame, other heat sources, or while stove is hot to the touch.

6. When manufactured, your Peak 1 stove is ready to be filled with Coleman fuel. The valve and generator must be changed before using kerosene. Be sure that you know if the fuel tank contains Coleman fuel or kerosene before lighting, and that the valve and generator is correct for the fuel.

7. FUEL

A) COLEMAN FUEL

This stove is designed to use Coleman fuel. Never use regular or premium leaded automotive fuel.

OR

B) KEROSENE

Always use clean, fresh, white kerosene to ensure a hot flame and to help prolong generator life.

8. Store fuel in a clean, properly marked, metal container. Use and store away from flame, (including pilot lights), or excessive heat.

9. **NEVER** allow tents, sleeping bags, clothing, or any flammable material to come within three feet (3') of the top, and one foot (1') of all the sides of the stove.

10. **NEVER** place heavy or large capacity utensils on stove. **NEVER** alter stove in any way, or use with any device or part not expressly approved by Coleman. **NEVER** use as a space heater. **NEVER** leave stove unattended while burning.

11. **NEVER** pump a stove while a utensil is on it.

12. **DO NOT** lean over stove while lighting.

13. **KEEP OUT OF REACH OF CHILDREN.**

2 To Fill Tank

NEVER FILL OR LIGHT STOVE INSIDE HOUSE, CAMPER OR TENT.

1. Extend feet and place stove on a smooth, LEVEL surface.
2. Be sure CONTROL KNOB is in "OFF" position (Fig. 1).
3. Close PUMP KNOB firmly. Turn in direction of arrow on pump knob. (Fig. 2)
4. Remove FUEL CAP. Use a funnel or suitable filling device and fill with clean, fresh fuel. **DO NOT TIP STOVE.** (Fig. 3)
5. Replace FUEL CAP on stove and fuel container. Tighten firmly. Move fuel container away from stove; **WIPE UP ANY SPILLED FUEL AND DISPOSE OF IN A SAFE PLACE.**

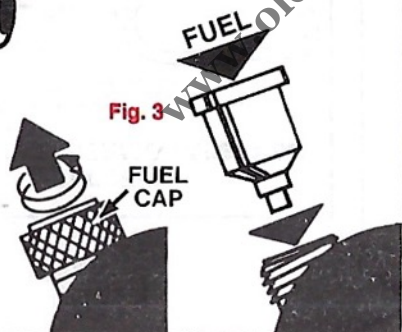
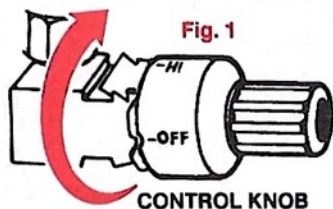

3 To Pump

1. Be sure CONTROL KNOB is in the "OFF" position. (Fig. 4).
2. **TEST PUMP** — With pump knob in closed position (TURN RIGHT) place thumb over hole in pump knob and PUMP. If little or no resistance is felt, oil, or replace pump cup. If pump resists, go to next step.
3. Open PUMP KNOB one turn.
4. With thumb over hole in PUMP KNOB, pump 25-50 full strokes of air into tank.
5. Close PUMP KNOB firmly to the right.

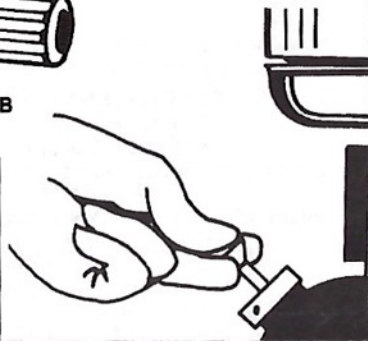
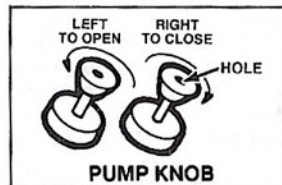
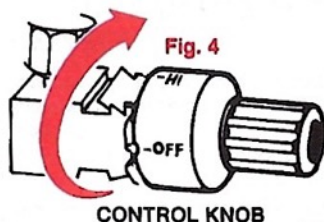

4 To Light

A. USING COLEMAN FUEL

1. Hold lighted match to burner bowl.
 2. Turn black CONTROL KNOB counter-clockwise to "HI" position (Fig. 5).
- NOTE:** If stove burns with a high yellow flame or if liquid fuel appears in the burner, turn Control Knob "off" and allow flame to burn out. Review instructions before relighting.
3. Pump an additional 15 to 30 strokes of air into tank. It may be necessary to repump stove occasionally during use for full heat output.

B. USING KEROSENE

1. Pre-heat generator by soaking pad, in area of generator, with alcohol or by placing a generous amount of pre-heating paste under the generator. Light the alcohol or paste.
2. When the pre-heating liquid or paste is almost consumed, turn black CONTROL KNOB counter-clockwise to "HI".

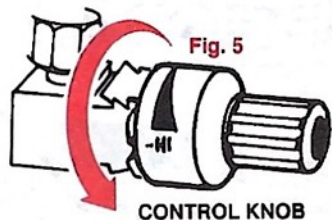
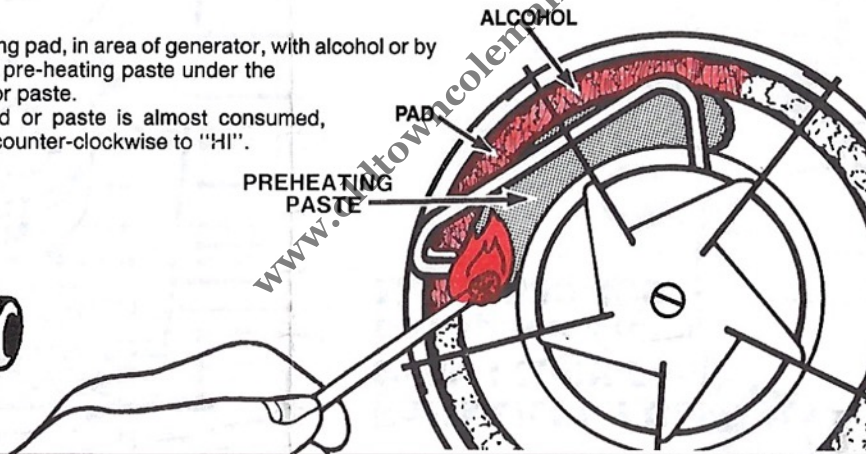
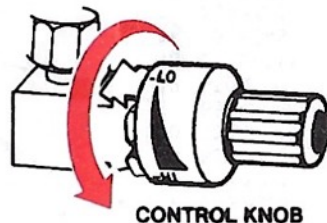

Fig. 5



5 To Regulate

1. Turn CONTROL KNOB counter-clockwise between "HI" and "LOW".



6

To Turn Off

1. Turn CONTROL KNOB fully clockwise to the "OFF" position, **DO NOT** force CONTROL KNOB past the "OFF" position.
2. Flame will slowly extinguish.

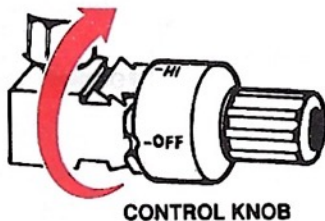

Things You Should Know

- Pre-heating paste is available at most stores that sell backpacking equipment.
- To reduce the possibility of rust and corrosion, flush tank and refill frequently with fresh fuel.
- Periodically, squirt a few drops of oil into the pump cap; this will keep the pump functioning properly.

