

# How To Use and Enjoy Your Coleman® Dual Fuel Lantern – model 285-700

U.S. PAT. NO. 4,522,582



## 3 Year Limited Warranty

Coleman will repair or replace, at its option, this product or any component found to be defective in materials or workmanship within three years of the original retail purchase.

This warranty is valid for the original retail purchase and is not transferable. Keep the original sales receipt. Proof of purchase is required to obtain warranty performance. Coleman dealers, service centers, or retail stores offering Coleman products do not have authority to alter, modify or in any way change the terms or conditions of this warranty.

### WHAT IS NOT COVERED

- Cost of shipment to Coleman
- Normal wear and tear, including chips, scratches, abrasion, discoloration or fading from use or exposure to sunlight
- Damage caused by misuse, abuse, neglect, alterations, repairs by unauthorized persons, use of non-Coleman accessories or parts, or failure to follow recommended care or maintenance instructions
- Products sold outside the United States, Puerto Rico, Virgin Islands, Guam, Canal Zone or American Samoa
- Products used for commercial purposes or in profit or non-profit instructional or rental operations
- Mantles, generators, light bulbs, batteries, fuel
- Consequential damages, incidental damages, or expenses, including damages to property. Some states do not allow the exclusion or limitation of incidental or consequential damages, so the above limitation or exclusion may not apply to you.

### IMPLIED WARRANTIES

Any implied warranties, including implied warranties of merchantability and fitness for a particular purpose, shall be limited to the duration and terms of the express warranties set forth in the limited warranty. Some states do not allow limitations on how long an implied warranty lasts, so the above limitation may not apply to you.

### HOW TO OBTAIN WARRANTY PERFORMANCE

Take the product to an authorized Coleman Service Center. If one is not conveniently located, attach a tag to the product which includes your name, address, telephone number and description of the problem. Include a copy of the original sales receipt. Carefully package the product and send prepaid either by U.P.S. or Parcel Post, insured, to: The Coleman Company, Inc., 3600 N. Hydraulic, Wichita, Kansas 67219. Please do not mail products with fuel in tanks, or with disposable propane cylinders. Remove glass globes from lanterns.

NOTE: To the extent any provision of this warranty is prohibited by federal, state, or local law and cannot be pre-empted, it shall not be applicable. This warranty gives you specific rights and you may also have other rights which vary from state to state.

3/92

THE COLEMAN COMPANY, INC.  
3600 N. Hydraulic, Wichita, Kansas 67219  
1-800-835-3278 • TDD: 316-261-3207

Made in United States of America

**THE COLEMAN COMPANY, INC.**

General Office and Factory: Wichita, Kansas U.S.A. 67219

285-0500 (10-92) P.I.

LITHO IN U.S.A.





# 1 Follow Instructions And Warnings To Avoid Injury Or Fires.

## WARNING:

1. Gasoline and Coleman fuel are extremely flammable, handle with extreme care. Fuel vapors are invisible, explosive, and can be ignited by ignition sources many feet away.
2. This lantern is designed to use unleaded automotive gasoline or Coleman fuel. Never use kerosene, gasohol, regular or premium leaded automotive fuel.
3. Store fuel in a clean, properly marked container away from flame (including pilot lights), other sources of ignition, or excessive heat.
4. Always fill outdoors. Never fill lantern, loosen or remove fuel cap while lantern is lighted, near flame (including pilot lights), other ignition sources, or while top of lantern is hot to touch.
5. Always light and use lantern outdoors; never inside house, camper, tent, or other unventilated or enclosed areas.
6. This lantern consumes air (oxygen). Do not use in unventilated or enclosed areas to avoid endangering your life.
7. Keep lantern away from flammables. Never allow fabric, clothing, or any flammable material to come within three feet of the top and one foot of the side of the lantern.
8. Use for lighting only. Never alter in any way or use with any device or part not expressly approved by Coleman. Do not use as a space heater.
9. Replace any mantle with a hole in it. A hole can cause lantern to overheat and create a hazard.
10. Keep out of reach of children.

## 2 To Fill

Always fill outdoors. Never fill lantern, loosen or remove fuel cap while lantern is lighted, near flame (including pilot lights), other ignition sources, or while top of lantern is hot to touch.

1. Turn FUEL VALVE to "OFF". (Fig. 1)
2. Close PUMP KNOB firmly. Turn in direction of arrow. (Fig. 2)
3. Remove FUEL CAP. Use a Coleman filter funnel and fill with clean, fresh fuel. Lantern must be in a level position. DO NOT TIP. (Fig. 3)
4. Replace FUEL CAP on lantern and on fuel container. Tighten firmly. WIPE UP ANY SPILLED FUEL AND DISPOSE OF IN A SAFE PLACE.

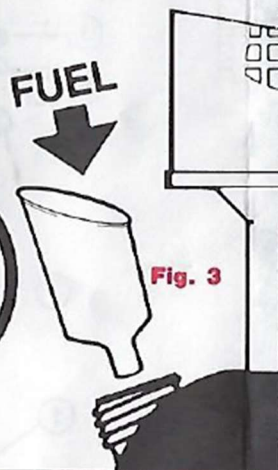
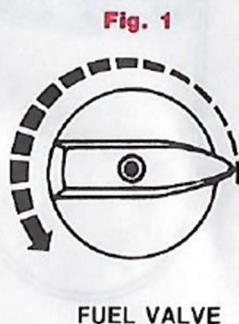

## 3 To Tie On Mantles

### 1. ALWAYS USE GENUINE COLEMAN MANTLES.

2. Tie MANTLES around grooves in BURNERS. (Fig. 4) Distribute folds of MANTLE evenly. CUT OFF SURPLUS STRING 1/4" FROM KNOT. EXCESS STRING CAN CAUSE HOLES IN MANTLE.

3. Light bottom of MANTLES evenly. Burn until nothing but white ash remains. Once the MANTLES have been burned they are very fragile. Be careful not to touch them with finger or match.

4. Allow MANTLES to cool before lighting lantern.

5. Install GLOBE, VENTILATOR and BALL NUT.

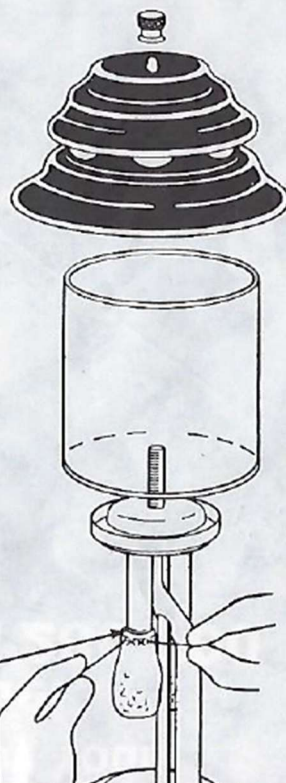

Fig. 4



## 4 To Pump

1. Be sure FUEL VALVE is "Off" and fuel cap is closed firmly.
2. Open PUMP KNOB one turn.
3. With thumb over hole in PUMP KNOB, pump approximately 30 strokes. If lantern is not full of fuel, more pump strokes are required. **GOOD AIR PRESSURE IS IMPORTANT.**
4. Close pump knob firmly.

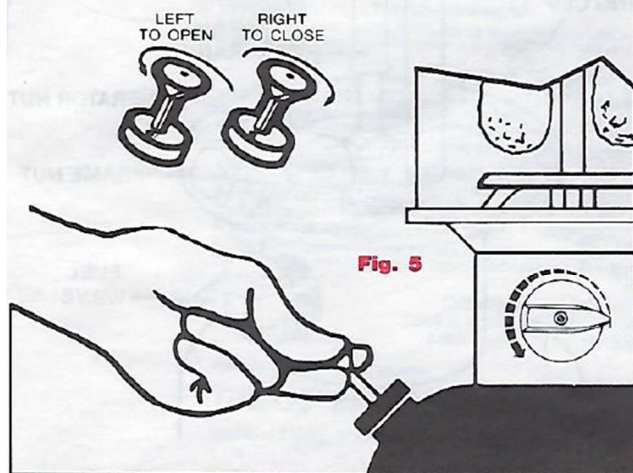

Fig. 5

## 5 To Light

1. Push lighted MATCH through lighting hole, hold near mantle and turn FUEL VALVE to "HIGH". Mantles will take a few seconds to light.

NOTE: a brand new lantern may take a full minute to light the first time.

- CAUTION:** Flames other than at mantles indicate flooding or a leak. Turn FUEL VALVE "OFF", allow flames to burn out and lantern to cool. Carefully review instructions and correct problem before relighting lantern.
2. Open PUMP KNOB and pump 15-25 strokes. Close PUMP KNOB.
  3. Adjust FUEL VALVE to desired brightness.
  4. To clean tip, turn FUEL VALVE from "HIGH" to "OFF" to "HIGH" several times.
  5. Additional pumping will be required at intervals. Good air pressure is important.

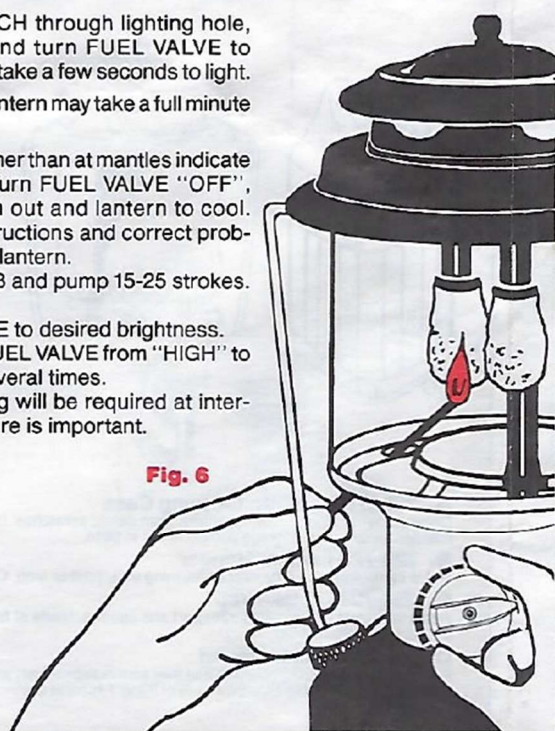

Fig. 6

## 6 To Turn Off

1. Turn fuel valve to "OFF". Light will dim and go out in about 1-2 minutes.

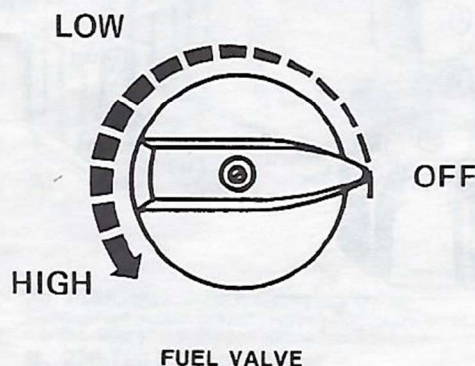

Fig. 7

## Things You Should Know

1. If lantern lights poorly or burns dimly, the generator gas tip may be clogged. To clean tip, turn FUEL VALVE from "HIGH" to "OFF" to "HIGH" several times.
2. Carry a spare set of Coleman Mantles. Once burned, a mantle is fragile and can be damaged if touched or dropped.
3. Unleaded fuels may vary in quality and can affect generator life. If you are having a problem with your lantern or generator using a certain brand of unleaded fuel, replace generator and try a different brand of unleaded fuel.
4. Rinse tank twice a year with fresh fuel to remove sediment, gum formations, and moisture accumulations.
5. Oil pump periodically to keep it working smoothly.
6. Part of the brightness control is located in the generator. If the lantern fails to adjust from High to Low properly, replace the generator.
7. The usual storage areas for camping and picnic equipment is the basement, attic, or garage. To avoid the accumulation of dust, cobwebs, etc. that is common in these storage areas, place your lantern in a plastic bag and seal it with a rubber band.
8. For repair service call 1-800-835-3278 TOLL FREE (Outside Kansas) — or 316-261-3312 (Inside Kansas) for location of your nearest Coleman Service Center. If lantern must be mailed to Service Center, attach your name, address, and a description of problem to product and mail to Service Center prepaid, less globe and ventilator to prevent breakage. If necessary to write the Service Center or factory, refer to your lantern as model 285-700.
9. If not completely satisfied with performance of this product, please call the toll-free number listed above. Do not return the product to the store where purchased.



## Parts List For Coleman® Dual Fuel Lantern model 285-700

I.D. No.	Part No.	Description	I.D. No.	Part No.	Description
1	21A1001	Manife	15	220C1401	Fuel Cap
2	288-1151	Heat Shield	16	285-5151	Fount. Assy.
3	231A3111	Spring Clip	17	200-6381	Check Valve Stem Assy.
4	285-5341	Burner Assy.	18	242-1071	Pump Cup Retainer
5	295-1641	Nut	19	216-1091	Pump Cup
6	288-1251	U-Clip Washer	20	242D5201	Punger Assy.
7	285-5891	Generator	21	288-5401	Frame Bottom
8	285-5571	Valve Assy.	22	214A0461	Globe
9	295-5051	Valve	23	285-5101	Ventilator & Bail Assy. (Black)
10	288-5491	Knob	24	288-441	Bail Nut
11	220C175	Screw			
12	288-1261	O-Ring			
13	288B5231	Feed Tube Assy.			
14	285-5291	Collar			

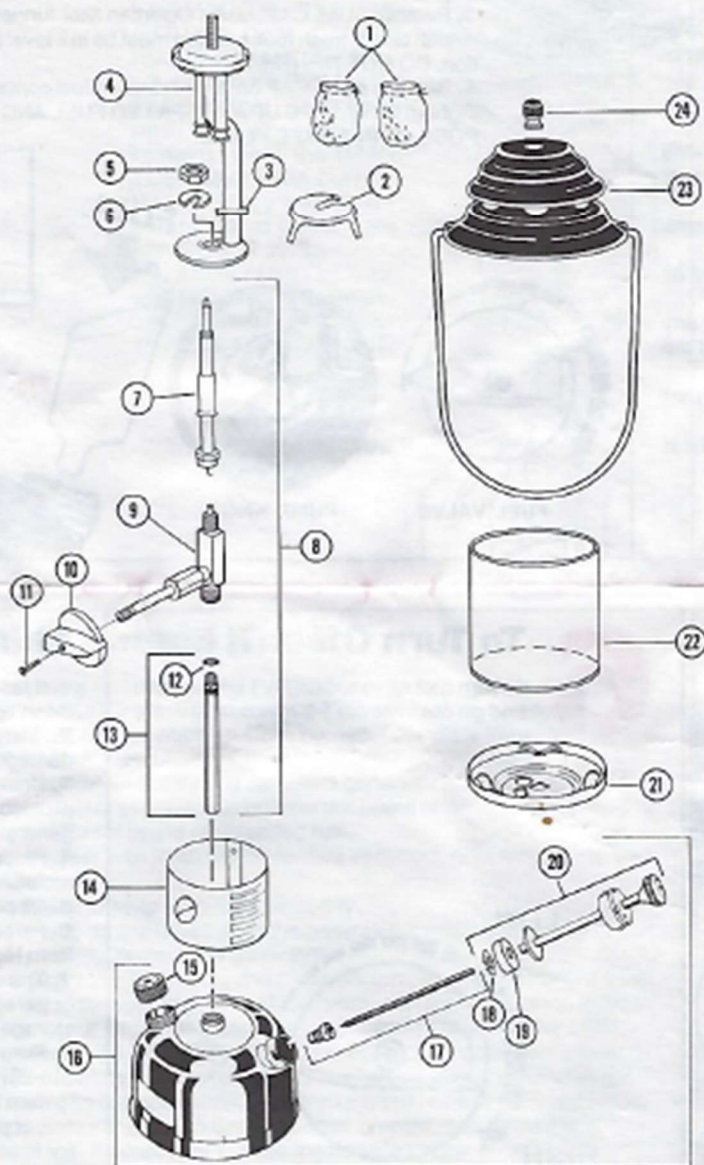

### Coleman® Lantern Accessories

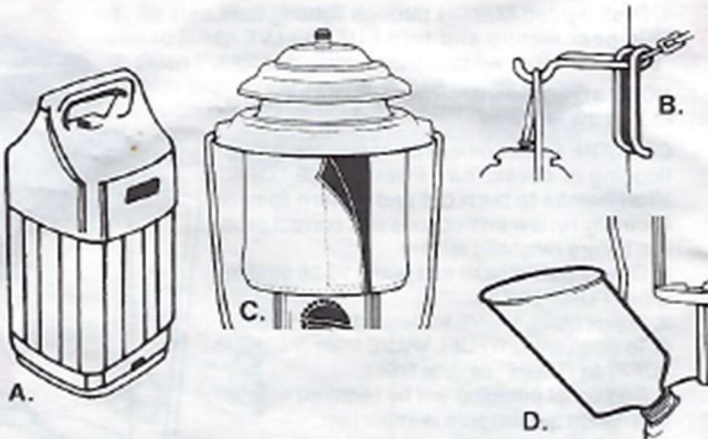

#### A. 288A763 Lantern Carrying Case

Compact lightweight, protects lantern from dents, scratches, broken globes, adds to the life of mantles. Spare parts storage compartment in base.

#### B. 220-720 Lantern Hanger

Holds camp light securely without harming tree, post or limb. Complete with hanger and chain.

#### C. 290-723 Globe Wrap

Helps to protect globe during transport and storage. Made of fabric-covered foam. Fits gas and propane frameless lanterns.

#### D. 5103-700 Filter Funnel

Removes dirt, water, or impurities that may accumulate in fuel cans. Fill stop feature helps prevent over-filling. Offset spout allows for ease of filling. Fits most Coleman liquid fuel stoves and lanterns.

## Generator Replacement

If your lantern is hard to light, burns dimmer than normal, or fails to adjust from "High" to "Low", the generator should be replaced.

1. Turn FUEL VALVE to "OFF". Remove BALL NUT on top of lantern and lift off VENTILATOR and GLASS GLOBE.
2. Remove SPRING CLIP and HEAT SHIELD.
3. Loosen bottom FRAME NUT, remove METAL CLIP, and lift BURNER from lantern.
4. Unscrew GENERATOR NUT, lift GENERATOR and unhook CLEANING ROD.
5. On new GENERATOR, pull CLEANING ROD out about 1/4 inch and re-hook cleaning rod. Carefully lower generator to avoid bending CLEANING ROD.
6. Finger tighten GENERATOR NUT.
7. Replace BURNER making sure top of generator fits into OPENING in AIR TUBE. Replace METAL CLIP and tighten bottom FRAME NUT.
8. Wrench tighten GENERATOR NUT firmly to form a leak tight joint. Avoid stripping threads.
9. Check MANTLES for damage and replace if needed. Reassemble lantern.
10. Visually check for leak immediately after lighting.

