

PARTS LIST
FOR

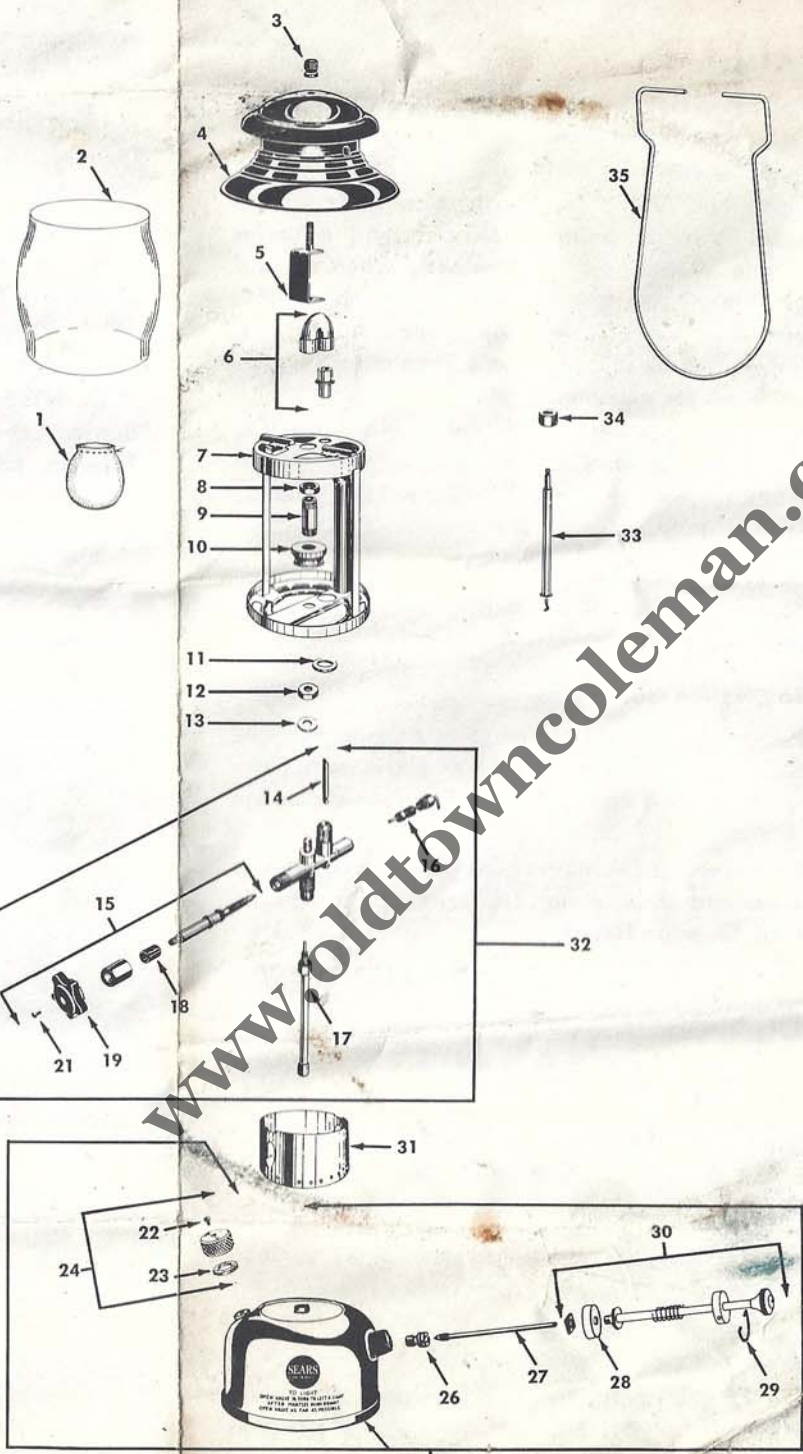

LANTERN
476.74550

CODE	PART NO.	DESCRIPTION
1	021A	Mantles (See Catalog Items below)
2	690A 051	Pyrex Clear Globe (See Catalog Items below)
3	203 - 441	Ball Nut (Ventilator)
4	270 - 4841	Ventilator
5	270 - 6631	Ventilator Bracket
6	200A3261	"U" Tube and Venturi
7	200A6621	Burner Frame Ass'y
8	200 - 4561	Lock Nut
9	200 - 3241	Burner Tube
10	242 - 3231	Burner Cap and Screen
11	1202B 261	Washer
12	426 - 426	Frame Nut
13	242A 333	Washer
14	242 - 3041	Eccentric Block
15	270 - 6531	Valve Stem Ass'y
16	202 - 3531	Tip Cleaner Stem
17	200 - 1481	Fuel and Air Wire Complete
18	242 - 6201	Valve Stem Packing
19	447 - 5491	Valve Wheel Ass'y
21	425 - 175	Self-tapping Screw
22	1059D1004	Screw for Filler Cap
23	220 - 6361	Gasket and Disc (Filler Cap)
24	220C1401	Filler Cap Complete
25	270 - 1651	Fount Complete
26	242B5381	Check Valve
27	200 - 533	Air Stem Assembly
28	216 - 5091	Pump Cup
29	530A5071	Pump Cap Clip
30	200A5201	Pump Plunger Complete
31	270 - 4891	Globe Base Rest
32	270 - 6571	Fuel Valve Complete (Less Generator)
33	200A5891	(T66DL) Generator (See Catalog Items below)
34	605 - 210	Jamb Nut
35	200 - 4231	Bail



www.oldtowncoleman.com

CATALOG ITEMS

These parts available at your nearest Sears retail store or catalog sales office

1	7116	021A	Mantles
2	7117	690A 051	Clear Globe
33	7115	200A5891	Generator

SEE YOUR AUTHORIZED SERVICE STATIONS FOR REPAIR PARTS

DIRECTIONS
FOR
OPERATING
AND
SERVICING



476.74550

LANTERN



TO OBTAIN SATISFACTORY RESULTS, READ AND FOLLOW THESE INSTRUCTIONS CAREFULLY STEP BY STEP

HOW TO USE YOUR 476.74550 LANTERN

Follow the directions and use only clean, fresh "White" unleaded gasoline for long, trouble-free service

To Fill

Close fuel valve tightly to the right. Remove Filler Cap and fill lantern with 2 pints of fresh, clean fuel. Never use fuel containing lead compounds or lubricating oils. Lantern should sit level all during filling. Fuel for the lantern should be strained through several thicknesses of finely woven cloth. After filling, replace Filler Cap and tighten firmly with fingers.

To Pump

Fuel Valve must be closed firmly. Turn Pump Plunger 2 turns to the left. Place thumb over small hole in end of Pump Plunger and pump 20 to 30 full strokes of air into lantern. Good pressure is important for maximum light and forming a new mantle. Now turn Pump Plunger to right until tight, then push it clear down. Oil Pump Leather occasionally to keep it soft and pliable.

To Tie On Mantle

Remove Ball Nut at very top of lantern. Remove Bail, lift off the Ventilator, and take out the Pyrex Glass Globe.

1. Tie mantle around groove in burner cap, cutting off excess string.
2. Distribute folds of mantle evenly around burner cap so it will not touch generator. Flat side of mantle should face generator.
3. Light bottom of mantle evenly with a match, letting it burn until nothing but the white ash remains.
4. Light the lantern using the following instructions. Good air pressure in the fount is necessary to properly shape a new mantle.

To Light

Rotate the Gas Tip Cleaning Lever at base of frame. Several turns will clean Generator Tip. Leave lever pointing down.

Open Fuel Valve one-fourth turn. Push lighted match through lighter hole and hold it under Mantle. Mantle will light instantly when air and gas mixture reaches it. After Mantle burns brightly, open Fuel Valve all the way to the left. Opening Valve all the way is important. Then pump in additional air for maximum light.

If lantern does not burn brightly with Fuel Valve wide open, rotate Gas Tip Cleaning Lever several times. Lantern may flicker a bit but will immediately burn brightly.

To Turn Out Light

Close Fuel Valve firmly. Light will go out in a few seconds.

To Change Generator

Remove Bail, Ventilator, and Pyrex Globe. Remove Nut which holds Burner and Frame to lantern. Carefully lift Frame up over Generator to avoid damage to Mantle.

Turn Gas Tip Cleaning Lever up. Remove Nut at lower end of Generator. Lift Generator up and unhook Cleaning Needle.

Pull end of Cleaning Needle out of new Generator far enough to hook into hole in Eccentric Block. After hooking Needle to Eccentric Block turn Gas Tip Cleaning Lever down. Slide Nut over Generator and tighten firmly with wrench to prevent a leak. Reassemble. Be careful when placing Frame down over Generator to avoid breaking Mantle.

Cleaning Lantern

Rinse Fount occasionally with clean fuel to remove sediment or moisture accumulations.

Clean Burner Cap Screen with small, stiff brush prior to installing new Mantle.

EMPTY FUEL if lantern will not be used for several weeks. Emptying prevents gum accumulating in Valve and Fuel Tubes.

GENERAL SUGGESTIONS

IF LANTERN BLAZES AND SMOKES more than a few seconds when first lit, then close valve and reopen one fourth turn as soon as light dims.

IF LANTERN DOES NOT LIGHT, check air pressure and fuel content. Remove Generator and unscrew Gas Tip to make sure point of needle has not been bent or curled. Open valve slightly to make sure gasoline will come through valve.

IF MANTLE TURNS BLACK, make sure screen in Burner Cap is clean and open. Check Air intake Tube for possible obstruction, such as a spider's nest.

IF LIGHT DIMS, check Fuel Valve to be certain it is wide open. Rotate cleaning lever to remove carbon, if any.

IF LIGHT PULSATES after installation of a new Generator, pump in additional air pressure until light is steady.

IF LANTERN IS ON EMERGENCY STANDBY in case of storm or power failure, when cool, empty all gasoline from Fount and refill with clean, fresh, fuel. Store in as cool a place as possible.

IF YOU HAVE OCCASION TO WRITE, mention your Lantern is a Model No. 476.74550. If you mail the Lantern, send it less Globe and Ventilator to avoid breakage.

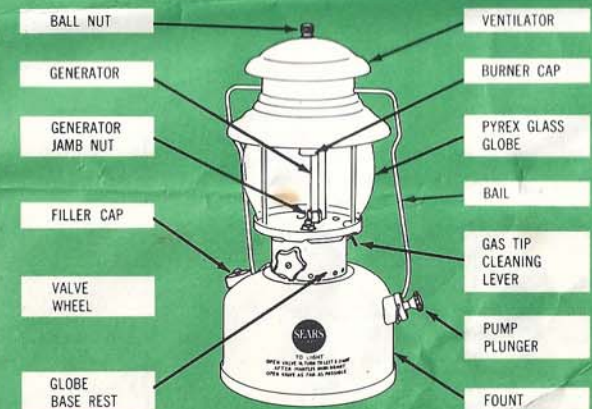

See Detailed Parts Diagram On Reverse Side