

FIRST PRODUCTION -

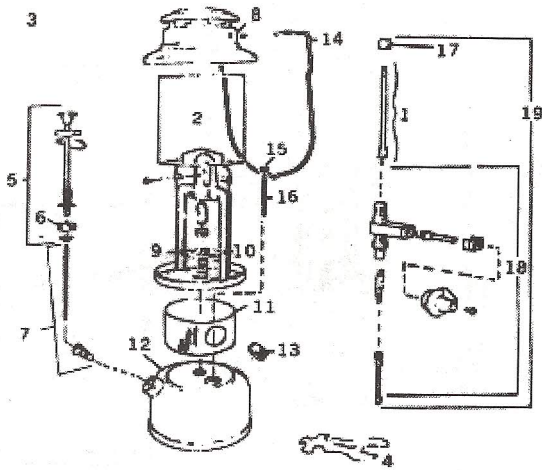

MODEL 325

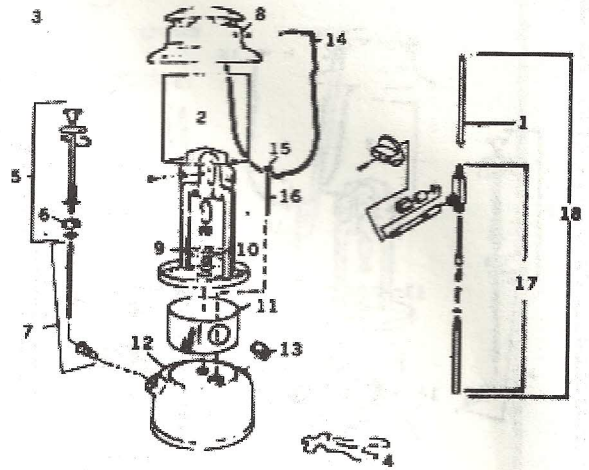

MODEL 325A

I.D.#	PART NUMBER	DESCRIPTION
1	G4*	Generator
2	4	Globe
3	999	Mantle
4	805A9505	Wrench (Accessory)
5	242D5201	Plunger Ass'y (Less Air Stem)
6	216-5091	Pump Leather & Washer
7	621-5361	Air Stem & Check Valve
8	339-4855	Ventilator
9	321-4605	Heat Shield
10	335-3265	Burner Frame
11	325-4895	Globe Base Rest
12	325-1595	Fount with Check Valve
13	425A1401	Filler Plug
14	335-4235	Bail
15	604A4565	Nut
16	321-6035	Stud
17	335-2105	Generator Jamb Nut
18	321C6565	Valve Ass'y (Less Generator)
19	325-6575	Valve & Generator Assembly

I.D.#	PART NUMBER	DESCRIPTION
1	G7	Generator
2	4	Globe
3	999	Mantle
4	805A9505	Wrench (Accessory)
5	242D5201	Plunger Ass'y (Less Air Stem)
6	216-5091	Pump Leather & Washer
7	621-5361	Air Stem & Check Valve
8	339-4855	Ventilator
9	321-4605	Heat Shield
10	335-3265	Burner Frame
11	325A4895	Globe Base Rest
12	325-1591	Fount with Check Valve
13	425A1401	Filler Plug
14	335-4235	Bail
15	604A4565	Nut
16	321-6035	Stud
17	325-6565	Valve Ass'y (Less Generator)
18	325A6575	Valve & Generator Assembly

*Not Available in U.S.A.